

**SSBK1250**  
**ShoreStation Hoist Trailer**

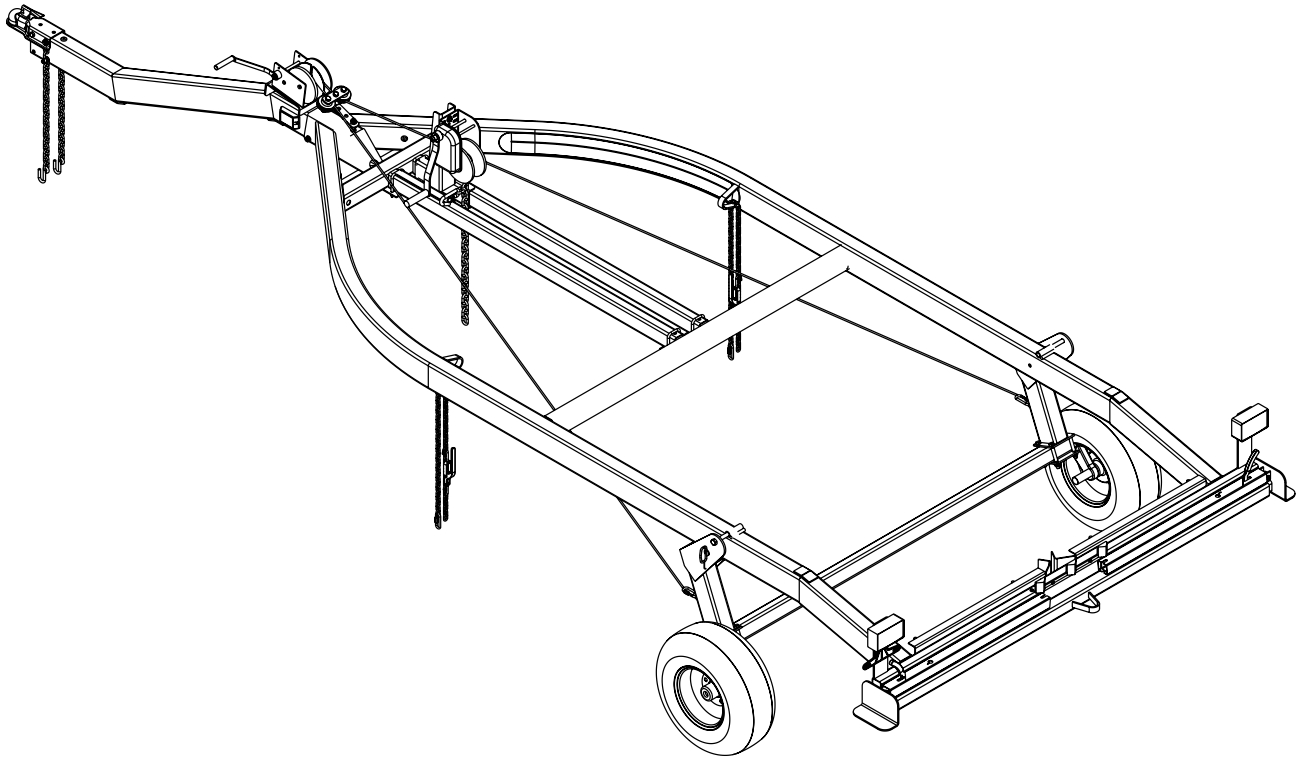

| PART #  | DESCRIPTION                       | QTY                               | NOTE |  |
|---------|-----------------------------------|-----------------------------------|------|--|
| 65135   | CAM LEVER ASSY                    | 2                                 |      |  |
| 67852   | WINCH SUPPORT TUBE HOIST TRAILER  | 2                                 |      |  |
| 67870   | AXLE PLATE HOIST TRAILER          | 2                                 |      |  |
| 67875   | ALUM EXT CHANNEL                  | 2                                 |      |  |
| 67879   | LOAD GUIDE CLAMP                  | 1                                 |      |  |
| 67880   | RAMP HOIST TRAILER                | 2                                 |      |  |
| 67881   | FRAME WMENT HOIST TRAILER         | 1                                 |      |  |
| 67882   | TONGUE WMENT                      | 1                                 |      |  |
| 67883   | WINCH POST HOIST TRAILER          | 1                                 |      |  |
| 67884   | AXLE PIVOT POST HOIST TRAILER     | 2                                 |      |  |
| 67885   | HOIST SUPPORTS HOIST TRAILER      | 2                                 |      |  |
| 67886   | PULLY WMENT HOIST TRAILER         | 1                                 |      |  |
| 68271   | TONGUE COVER PLATE                | 1                                 |      |  |
| 0110037 | HH 3/8-16 X 1 1/4 CS GR5          | 2                                 |      |  |
| 0110049 | HH 3/8-16 X 2 1/4 CS GR5          | 2                                 |      |  |
| 0110096 | HH 1/2-20 X 1-1/2                 | 1                                 |      |  |
| 0110107 | HH 1/2-13 X 3 CS GR5              | 3                                 |      |  |
| 0110114 | HH 1/2-13 X 4 CS GR5              | 10                                |      |  |
| 0120195 | HH 5/8-18 X 4 1/2 CS GR5          | 2                                 |      |  |
| 0140040 | HH 3/8-16 X 1 CS GR5              | 5                                 |      |  |
| 0140090 | HH 1/2-13 X 1 CS GR5              | 2                                 |      |  |
| 0210032 | CARR 1/4-20 X 3/4 GR5             | 3                                 |      |  |
| 0310103 | SUB 3/8 X 2 7/16 X 4              | 4                                 |      |  |
| 0810925 | SCREW SELFDRIILL HWH #10-16 X 3/4 | 7                                 |      |  |
| 1310004 | LOCKWASHER 1/4 INTERNAL TOOTH     | 2                                 |      |  |
| 1310170 | WASHER#10 USS FLAT                | 2                                 |      |  |
| 1340095 | WASHER USS FLAT 3/8               | 10                                |      |  |
| 1340100 | WASHER USS FLAT 1/2               | 1                                 |      |  |
| 1410049 | HEX NUT FINISH 1/4-20             | 2                                 |      |  |
| 1410209 | HEX LOCKNUT 1/2-20                | 1                                 |      |  |
| 31      | 1440101                           | HEX LOCKNUT FLANGE 3/8-16 W/T&T   | 19   |  |
| 32      | 1440102                           | HEX LOCKNUT FLANGE 1/2-13 W/T&T   | 17   |  |
| 33      | 1440279                           | HEX LOCKNUT 5/8-11 GRADE B        | 2    |  |
| 34      | 1920013                           | QUICK LINK 1/4(7MM) PLATED        | 2    |  |
| 35      | 2121223                           | SPRING DOCK CAM LEVER             | 2    |  |
| 36      | 2210171                           | CHAIN QUICK LINK W/5/16 OPENING   | 2    |  |
| 37      | 2210300                           | CHAIN SAFETY 1/4(7MM)X 20LK W/LA  | 2    |  |
| 38      | 2210304                           | LOAD BINDER MITIE                 | 2    |  |
| 39      | 2210305                           | CHAIN 4/0 STRAIGHT COIL X 70 LIN  | 2    |  |
| 40      | 3110208                           | WINCH B1500 BRAKE WINCH           | 1    |  |
| 41      | 3110302                           | WINCH HANDLE 9 1/2IN B1200        | 1    |  |
| 42      | 3110334                           | 1/2 X5 HITCH PIN W/LYNCH          | 1    |  |
| 43      | 3110377                           | DBL2000 WINCH SPLIT DRUM W/HANDLE | 1    |  |
| 44      | 3110378_FORM                      | CABLE 1/4" X 304 W/LOOPS GALV     | 1    |  |
| 45      | 3110379                           | CABLE WITH CHAIN AND HOOK         | 1    |  |
| 46      | 3310010                           | COUPLER #980 P2 ASSEMBLED         | 1    |  |
| 47      | 3510022                           | GROMMET 7/16IN MOLDED             | 2    |  |
| 48      | 3510030                           | GROMMET 7/8IN MOLDED              | 5    |  |
| 49      | 3510037                           | AXLE HOIST TRAILER                | 1    |  |
| 50      | 3510083                           | PULLEY WITH BRASS BUSHING 2 7/8   | 2    |  |
| 51      | 3510570                           | LATCH HANDLE PLASTIC COVER - DOC  | 2    |  |
| 52      | 4300181                           | 20.5 X 8 X 10-D TIRE/MSILVER RIM  | 2    |  |
| 53      | 5110045                           | 3 LIGHT CLUSTER 1994 LEXAN        | 1    |  |
| 54      | 5110348                           | BO LICENSE PLATE BRACKET          | 1    |  |
| -       | 5110354                           | HARNESS FRAME 2X4 LEFT 17FT 21    | 1    |  |
| -       | 5110355                           | HARNESS FRAME 2X4 RIGHT 17FT 2    | 1    |  |
| 55      | 5110377                           | TAILLIGHT RIGHT DRYLAUNCH         | 1    |  |
| 56      | 5110378                           | TAILLIGHT LEFT DRYLAUNCH          | 1    |  |
| -       | 5110426                           | HARNESS TONGUE 9FT 2FT SHEATH     | 1    |  |
| 57      | 5110456                           | LIGHT AMBER SIDE MARKER 42IN WI   | 2    |  |

## SSBK1250 Assembly Instructions

### Safety Chains:

Insert a 3/8" X 1-1/4" hex bolt with a 3/8" flat washer and safety chain through the lower hole on the front of the tongue. Secure with a 3/8" flat washer and 3/8" flange lock nut. Repeat the procedure on the opposite side of the tongue.

### Coupler:

Mount the coupler onto the tongue with one (1) 1/2" X 4" hex bolt into the rear of the coupler and tongue. Using two (2) 1/2" X 1" hex bolts insert in to the two (2) front holes through the coupler and tongue. Secure with 1/2" flange lock nuts.

### Tongue:

Slide the tongue assembly into the tongue frame cap. Secure the tongue with a 1/2" X 4" hex bolt in the side of the tongue and the tongue channel.

### Wire Harness:

Install the tongue wiring and harness through the top forward wire hole and exit the rear of the tongue tube. Install grommets and plug the tongue wire into the frame harness by color.

### Tongue Cover:

Pull the wiring through the tongue cover. Place the tongue cover over the rear of the tongue and the tongue frame cap and secure with a 1/2" X 1-1/2" hex bolt, 1/2" flat washer and 1/2" hex lock nut.

### Winch:

Mount the winch assembly to the tongue plate weldment using three (3) 3/8" X 1" hex bolts, 3/8" flat washers and 3/8" flange lock nuts.

### Cables:

Find the center of the continuous cable and mark. Insert the cable at the mark into the center split on the drum of the winch. Turn winch handle to start the cable around the winch drum.

### Brake Winch Assembly:

The brake winch assembly is partially assembled with one (1) winch support tube already in mounted into position. Slide the other winch support tube into position on the opposite side of the winch post. Secure this assembly the SSBK1250 trailer frame at the middle and front crossmember locations using four (4) 3/8" X 2-7/16" X 4" square u-bolts. Tighten using 3/8" flange lock nuts.

### Load Binder Chains:

Run the end of the chain closest to the chain binder (about 17 links in) through the welded loop on the inside of the side frame and connect with a quick link. Repeat on opposite side of the trailer.

### Axle:

Cut the banding holding the axle assembly to the frame. This allows the axle assembly to drop into a down position.

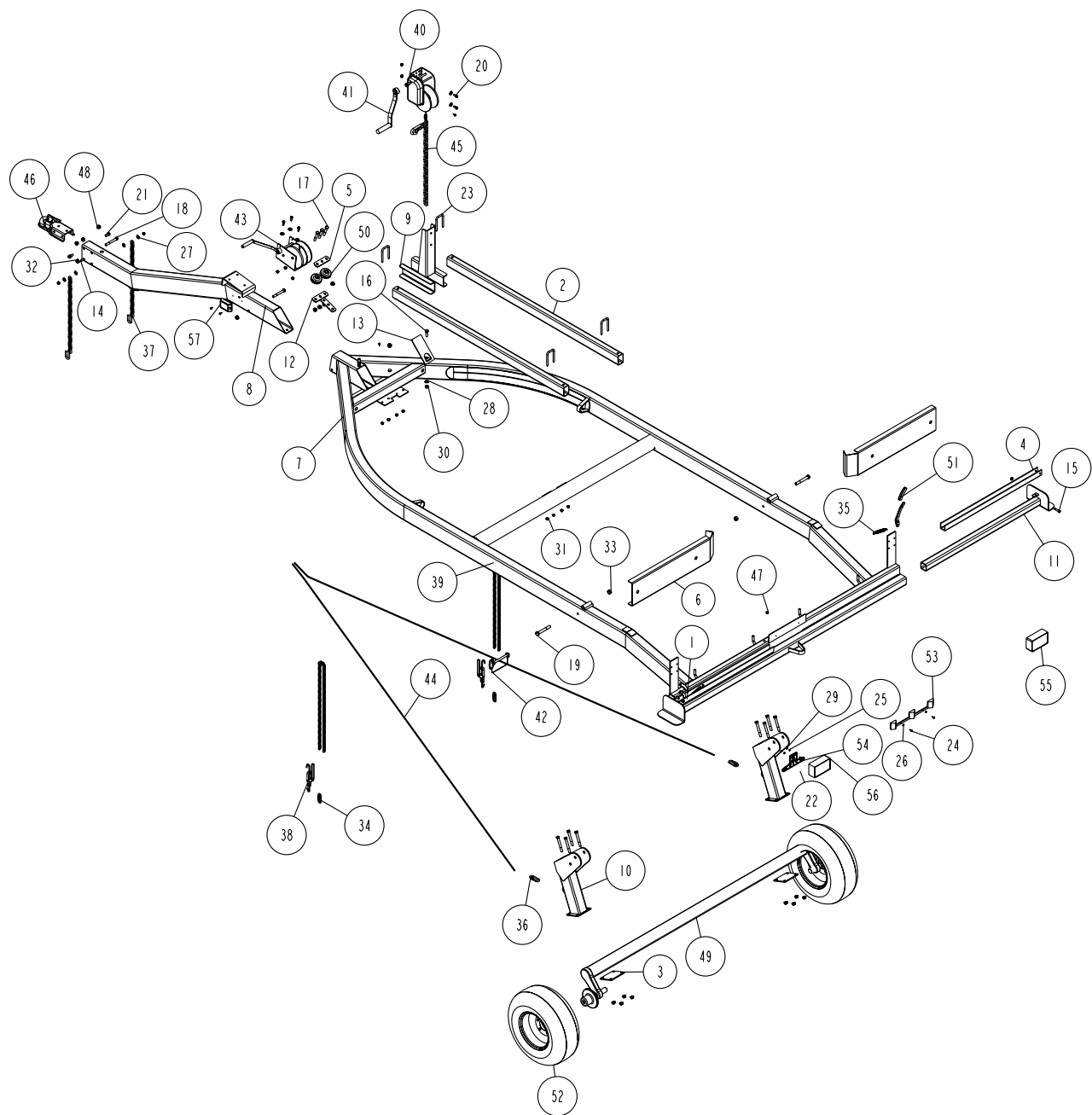

# SSBK1250 Operating Instructions

## OPERATING INSTRUCTIONS

1. Check local D.O.T. regulations to ensure that loaded trailer will not exceed height and width limitations.
2. Raise hoist platform to highest position.
3. Back trailer up to hoist centered with wheels approx. 36" from hoist. Remove ramps from trailer and hook over hoist frame, aligned with wheels.
4. Back trailer over ramps into hoist frame, stopping approx. 18" from back of hoist. Return ramps to trailer frame.
5. Lower trailer frame with wheel assembly winch until support arms slide under hoist's lower side frame.
6. With trailer centered, slide left and right support arms out until tight against hoist frame. Note that support arms slide out freely but cannot be retracted until locking lever is released.
7. Hook front winch cable chain around hoist's front cross frame. Position winch directly above lower frame and raise hoist until it is against bottom of trailer frame. If not possible reposition trailer. Do not over crank.
8. Raise back of hoist with wheel assembly winch to fully upright, transport position. Do not over crank. Secure chassis with locking pins.
9. Secure tie downs around hoist side frames and thru tie down points on inside front corner of trailer frame to keep hoist from shifting during transport.
10. Hoist is now ready for transport.

To remove hoist from trailer, reverse the above processes.

**Read owners manual before using.**

4811463

*Actual Decal - located on the tongue of the SSBK1250.*