

HA0072-00 132" Drop Side Kit for 5,000 lb. Hoists

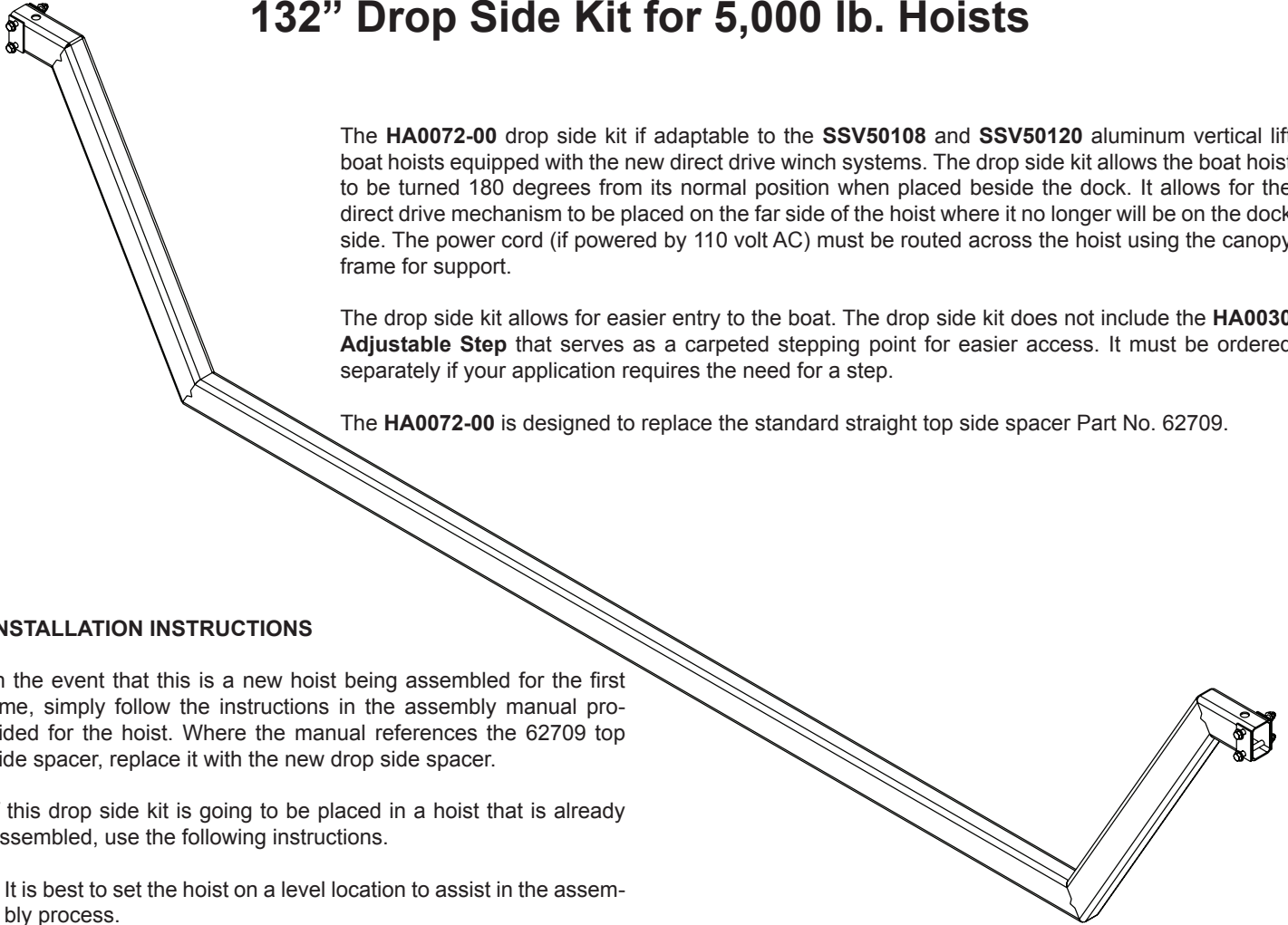

The **HA0072-00** drop side kit is adaptable to the **SSV50108** and **SSV50120** aluminum vertical lift boat hoists equipped with the new direct drive winch systems. The drop side kit allows the boat hoist to be turned 180 degrees from its normal position when placed beside the dock. It allows for the direct drive mechanism to be placed on the far side of the hoist where it no longer will be on the dock side. The power cord (if powered by 110 volt AC) must be routed across the hoist using the canopy frame for support.

The drop side kit allows for easier entry to the boat. The drop side kit does not include the **HA0030 Adjustable Step** that serves as a carpeted stepping point for easier access. It must be ordered separately if your application requires the need for a step.

The **HA0072-00** is designed to replace the standard straight top side spacer Part No. 62709.

INSTALLATION INSTRUCTIONS

In the event that this is a new hoist being assembled for the first time, simply follow the instructions in the assembly manual provided for the hoist. Where the manual references the 62709 top side spacer, replace it with the new drop side spacer.

If this drop side kit is going to be placed in a hoist that is already assembled, use the following instructions.

- It is best to set the hoist on a level location to assist in the assembly process.
- Remove all weight from the hoist platform.
- Lower the platform to its lowest position so it is resting on the lower frame of the hoist.
- Loosen and remove the nut securing the end on one of the level cables on the top side of the post brace. Remove the flat washer and the aluminum washer located beneath the nut. Remove the level cable.
- Repeat the prior step on the remaining level cable on the other end of the hoist.
- Loosen the nuts securing the 1" clamps around the upright posts. Remove one of the bolts on each end of the post brace.
- Carefully remove the final bolt on one end of the post brace. Note that there are shims between the 1" clamps and the post brace that could drop out once the final bolt is removed. Remove the shims.
- Repeat on the other end of the post brace.
- Remove the top side spacer.
- Replace the top side spacer with the new drop side tube.
- Replace the shims just removed. Align the hole in the 1" clamp, shim, and drop side tube. Re-insert the 3/8" x 3 3/4" bolt just removed. Replace the flange lock nut.
- Repeat the above process on the other end of the drop side tube.
- Align the second hole of the shim with the drop side tube. Adjust the 1" clamp up or down to match the holes in the shim and drop side tube. Insert the other 3/8" x 3 3/4" hex bolt through these aligned holes. Secure with another flange lock nut. Repeat this process on the other end of the drop side tube.
- Adjust the drop side tube up or down so the bottom of the 1" clamp is at the point of the arrow decal. Tighten in this position. Repeat on the other end of the drop side tube.
- Place the threaded end of the level cable up through the hole

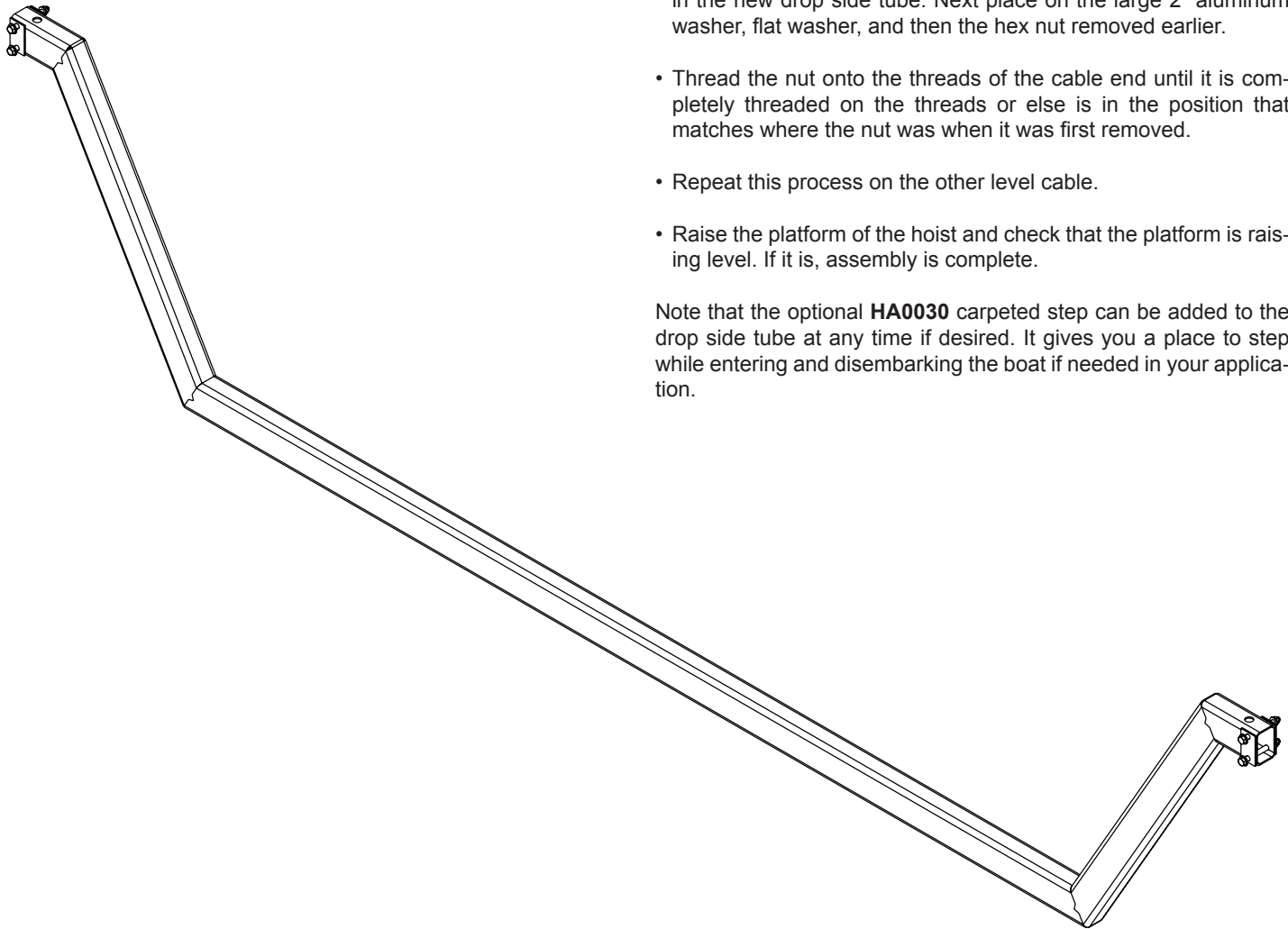

in the new drop side tube. Next place on the large 2" aluminum washer, flat washer, and then the hex nut removed earlier.

- Thread the nut onto the threads of the cable end until it is completely threaded on the threads or else is in the position that matches where the nut was when it was first removed.
- Repeat this process on the other level cable.
- Raise the platform of the hoist and check that the platform is raising level. If it is, assembly is complete.

Note that the optional **HA0030** carpeted step can be added to the drop side tube at any time if desired. It gives you a place to step while entering and disembarking the boat if needed in your application.

ITEM	PART #	DESCRIPTION	QTY	NOTE
1	69539	SHIM PLATE 1/8 ALUM DROP SIDE	4	
2	69541	DROP SIDE WMENT 132IN 50 HOIST	1	
3	0110059	HH 3/8-16 X 3 3/4 CS GR5	4	
4	1340095	WASHER USS FLAT 3/8	4	
5	1440101	HEX LOCKNUT FLANGE 3/8-16 W/T&T	4	

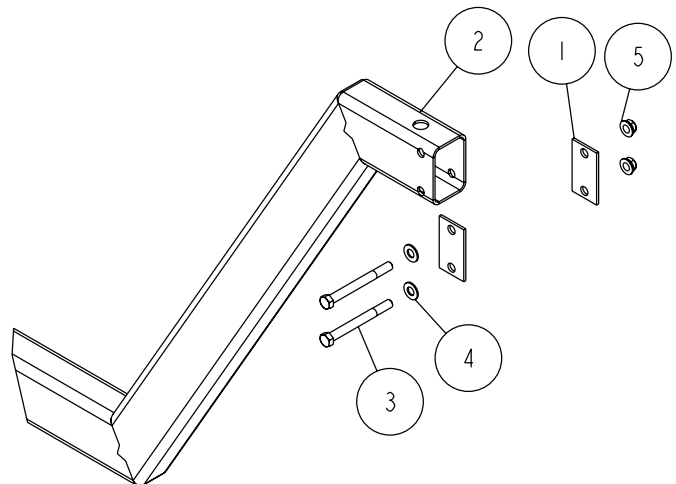

SCALE 0.125