

**HA0127
BUNK POLY 15100/20100 HOIST ALUM EXTRUSION**

The assembly of this kit starts with opening the bundles by cutting the banding and you will then open the bag and sort the hardware by size.

With this complete you will now slide a 3/8-16 X 4 7/16 X 3 stainless steel square u-bolt over the aluminum v-frame extrusion from the outside in. Once the height of the bunk is determined the adjustable bunk bracket will be slid over the square u-bolts and all will be secured with a stainless steel flat washer and a brass locknut with nylon insert. This process will be repeated for the other three adjustable bunk brackets. With the brackets in place mount the poly bunks on top of the brackets with the notched stop to the entry end of the hoist. Secure with 3/8 X 1 stainless steel hex bolts and brass locknuts with nylon inserts. These will not be secured tightly until the width from each other or from the center of the hoist and height above the aluminum v-frame is set on all of the brackets.

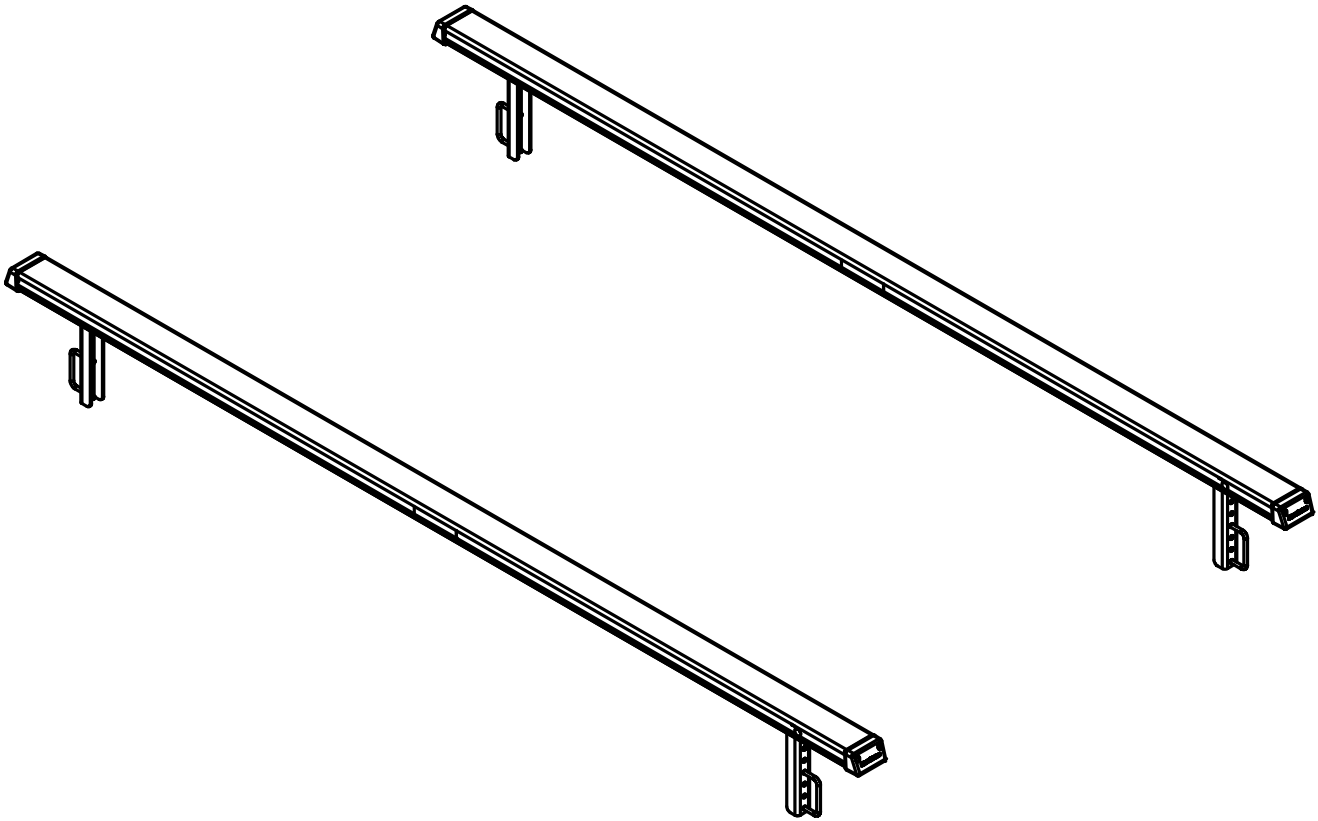
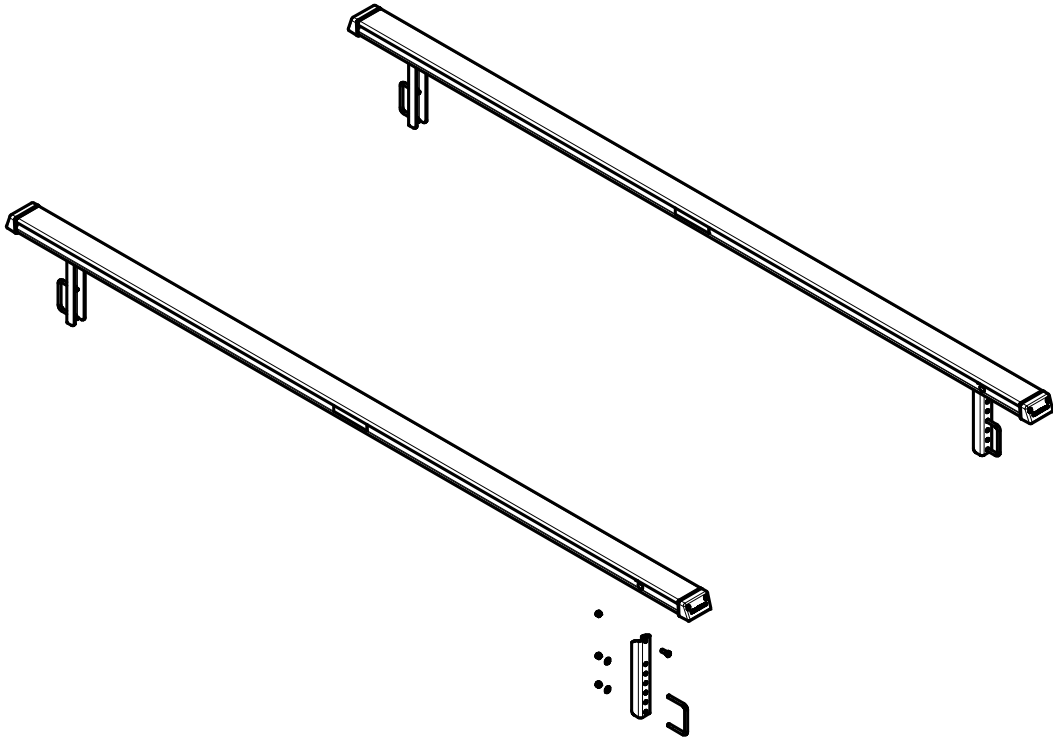

ITEM	PART #	DESCRIPTION	QTY	NOTE
1	69029	BUNK ASSY 10FT POLY	2	
2	70815	BUNK BRKT ALUM ADJ BOAT LIFT	4	
3	0150040	HH 3/8-16 X 1 CS STAINLESS	4	
4	0350400	SUB 3/8-16 X 4 7/16 X 3 SS	4	
5	1350095	WASHER USS FLAT 3/8 STAINLESS	12	
6	1440366	HEX LOCKNUT 3/8 BRASS/NYLON INSERT	12	

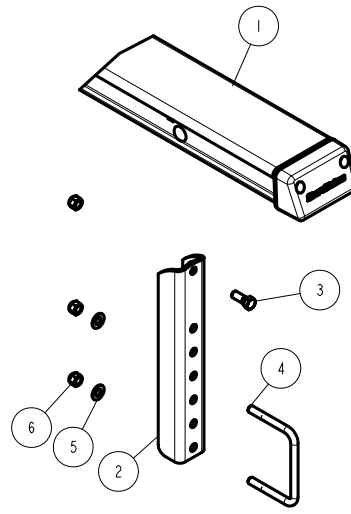

SCALE 0.125

At this time you will need to load the boat on the hoist to make sure all clearances are correct and all adjustments are made.