

HA0017
Elevating Arm Kit

HA0018
Spindle Mounting Kit

For Roll-in Hoist Applications

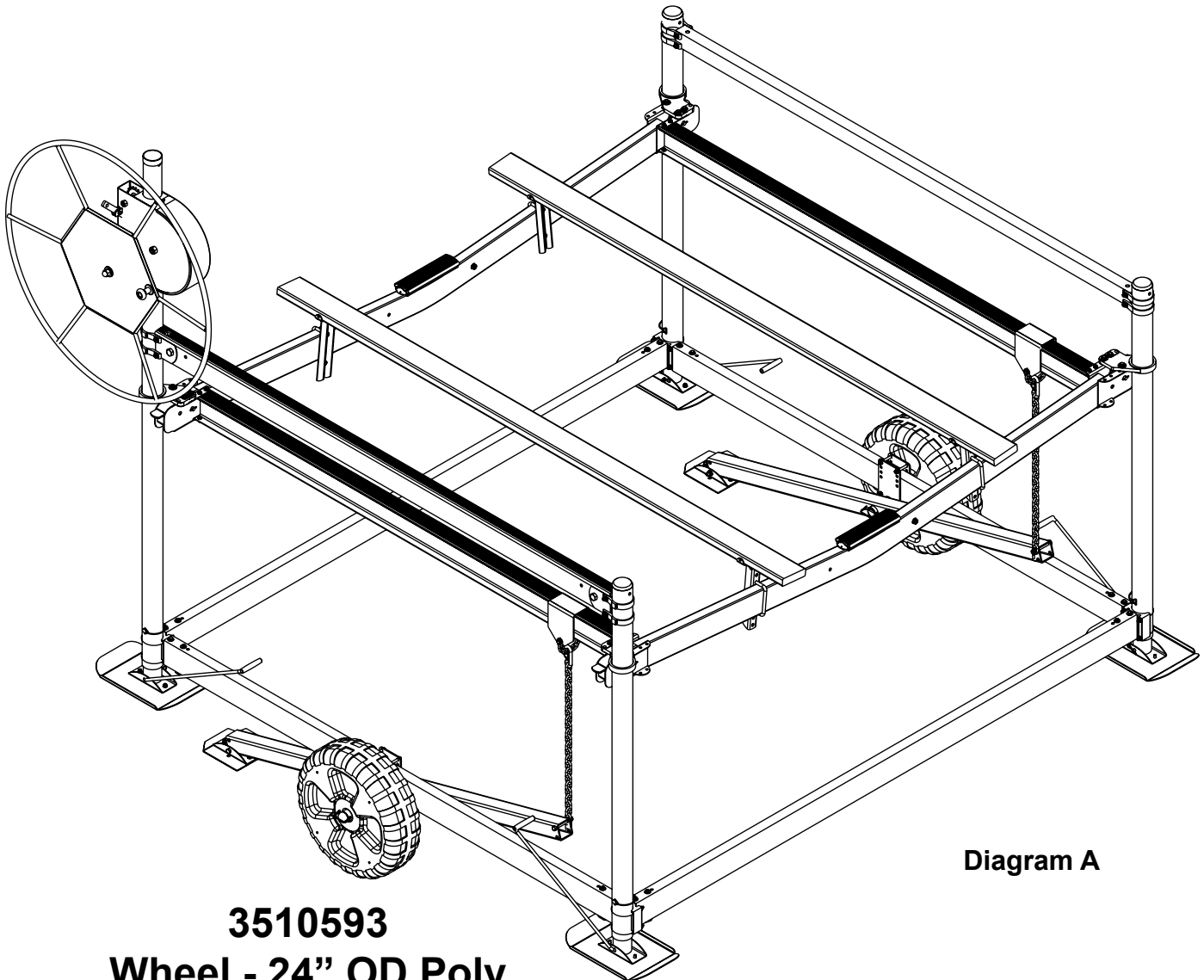

Diagram A

3510593
Wheel - 24" OD Poly
Wheels must be ordered separately.

Table of Contents:

Safety Instructions	2
Maintenance	2
Warranty	2
Assembly.....	3-6
Installation.....	6-8
HA0017 (Elevator Arm Kit) Parts Drawing.....	9
HA0018 (Spindle Mounting Kit) Parts Drawing.....	10

Safety Instructions:

SAFETY INSTRUCTIONS

This roll-in hoist system is designed to fit only **ShoreStation** hoist models with lifting capacities of 1500-6000 lbs.

Maximum lifting capacity is 1400 lb. (700 lb. per arm).

Do not attempt to install or remove hoist in adverse weather conditions.

Remove the boat from hoist prior to installation or removal.

Remove canopy cover prior to installation or removal.

Roll-in hoist system is not designed for road use.

Roll-in system can be stored on hoist only if the weight of the hoist is resting on leg base pads.

Remove lift chains from platform lift brackets before raising boat on the hoist platform.

Midwest Industries, Inc.
D501250

800.859.3028

www.shorestation.com
4850407

Maintenance:

At the end of the boating season, check wheel drain holes to make sure they are clean of mud and debris so the water will drain. Water trapped inside the wheel will freeze over the winter and may damage the wheel.

Warranty:

Due to the anticipated commercial use of this item, the HA0017 & HA0018 installation kits are **NOT** covered by any warranty.

Assembly:

Step 1 - Installing Spindle Assemblies

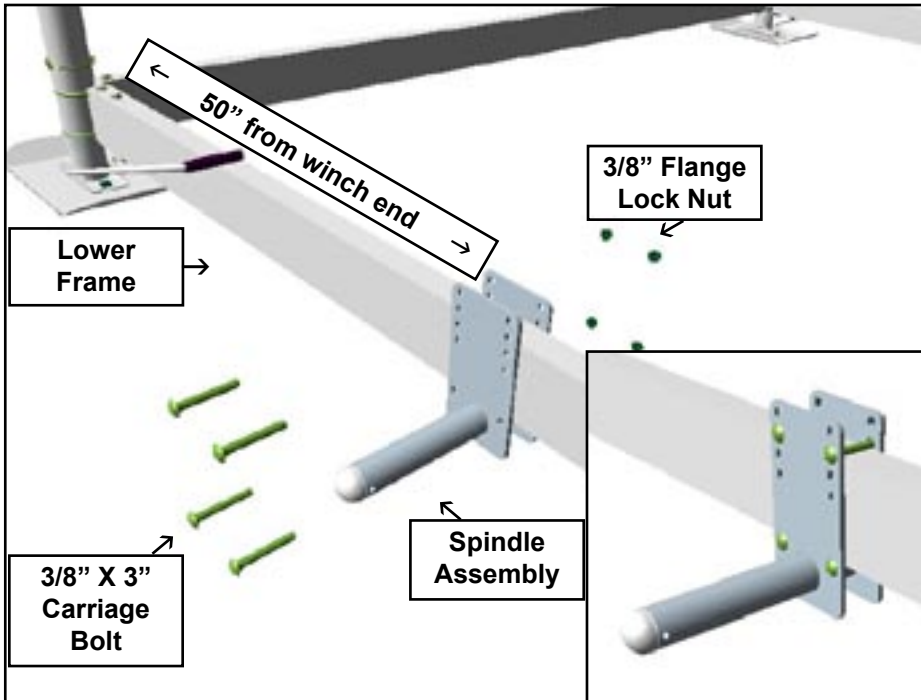

Install spindle assembly 50" from the winch end hoist.

Place spindle assembly on lower frame tube with long end of spindle facing outward as shown aligned with mark.

Assemble using carriage bolts as shown. Use appropriate mounting holes to match lower frame size.

Tighten flange lock nuts.

Repeat on opposite side of hoist.

Step 2 - Installing Wheels

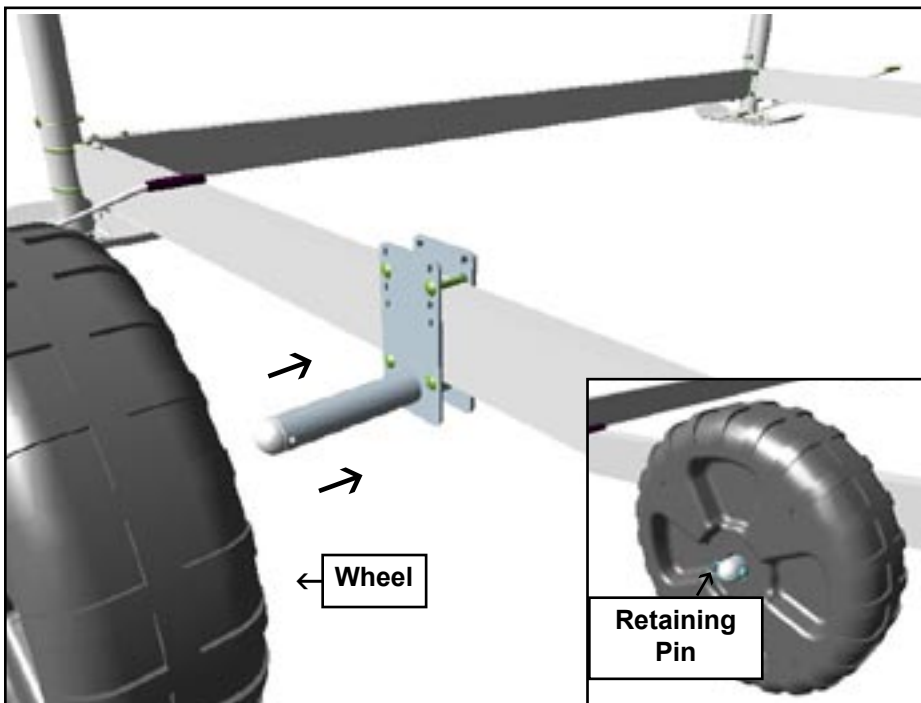

Slide wheel onto spindle and secure with retaining pin.

Hoist may need to be raised to gain adequate wheel clearance.

Wheel will only fit one way.

Step 3 - Assembling Base Pads

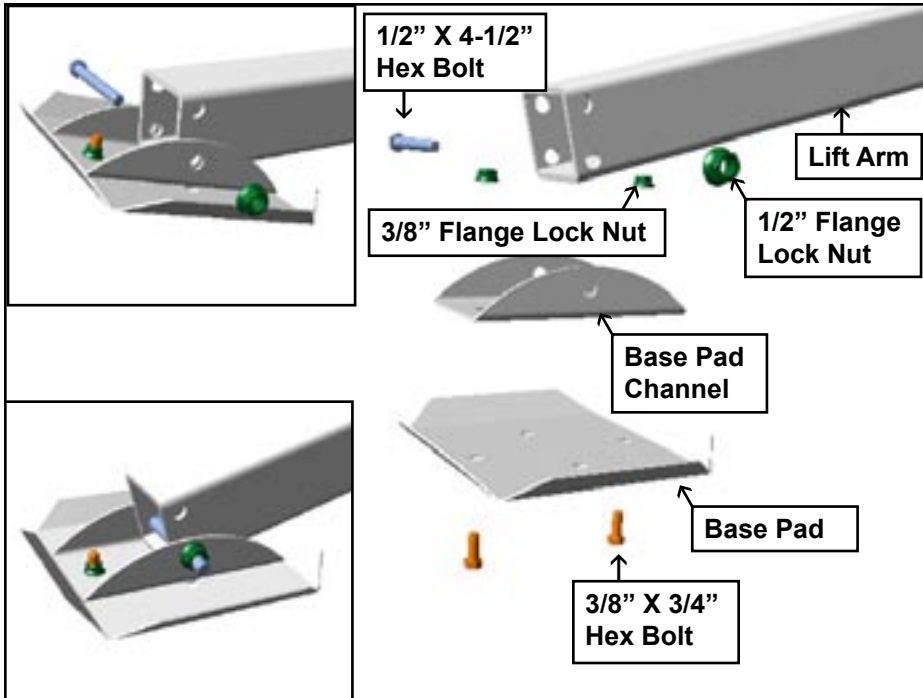

Assemble base pad to channel using hardware shown.

Assemble base pad and channel to lift arm using hardware shown. Do not over tighten. Pad must be able to pivot on 4-1/2" hex bolt.

Step 4 - Attaching Lift Chain

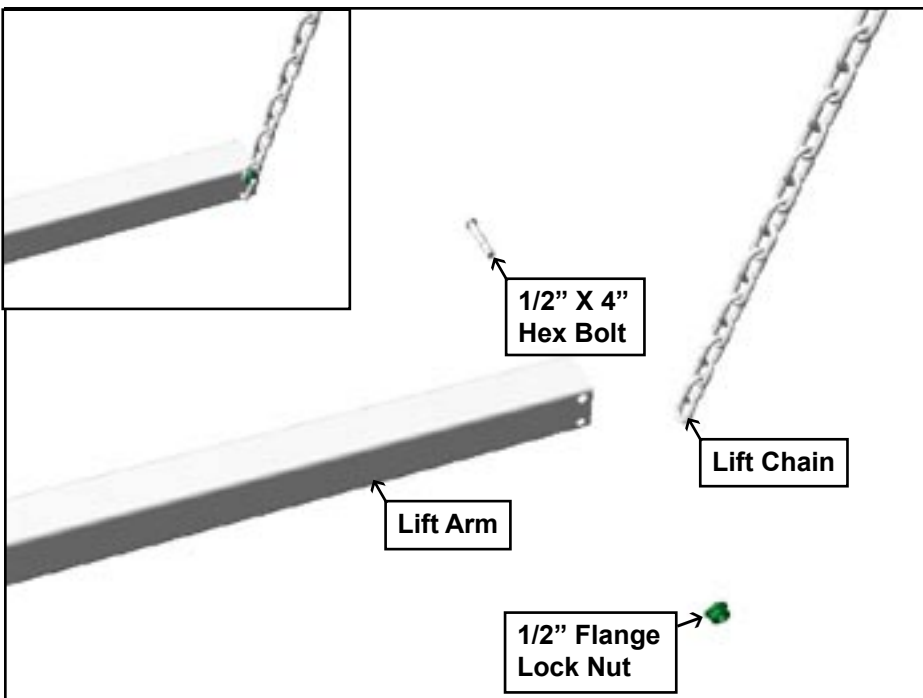

Assemble lift chain to the other end of lift arm using hardware shown.

Note: The chain on the second lift arm must be mounted on the opposite side of the tube as shown in Diagram A, Page 1 to keep the lift chain directly under the center of the I-beam.

Refer to picture 7, page 6 for another view.

Step 5 - Attaching I-Beam Bracket

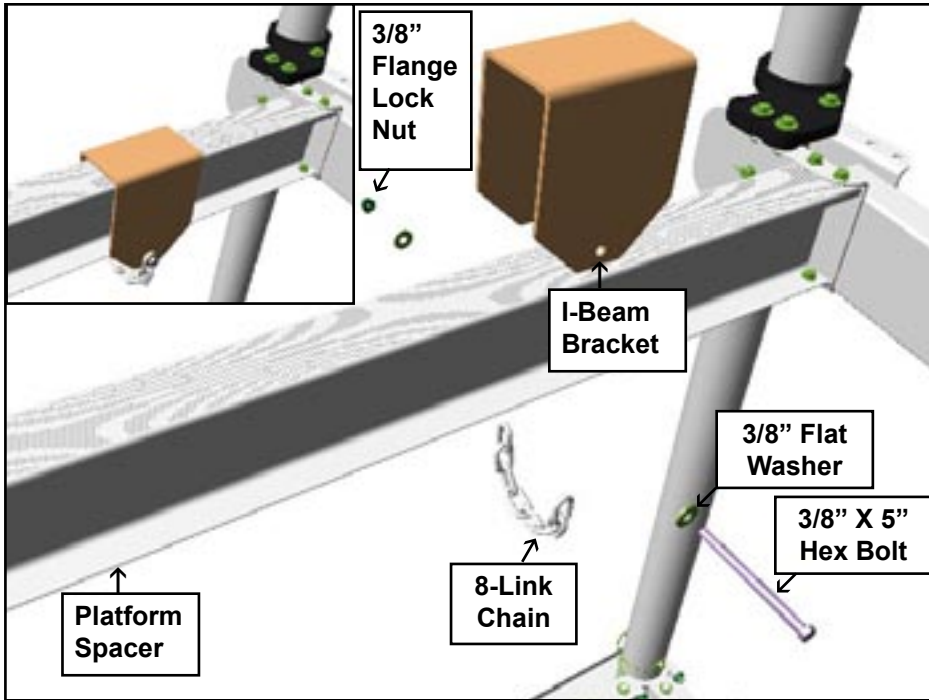

Place I-beam bracket over platform spacer.

Assemble ends of 8-link chain using hardware as shown.

Repeat on opposite side of hoist.

Step 6 - Attaching Lift Arm to Spindle

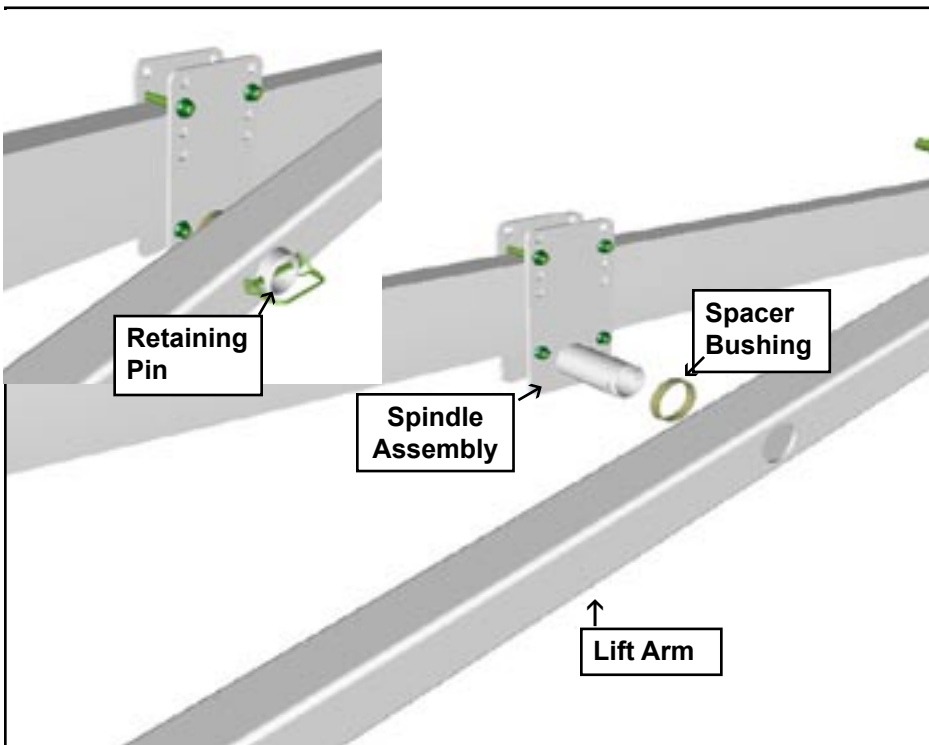

Place spacer bushing on the spindle assembly.

Slide lift arm on spindle assembly.

NOTE: Lift chain must be positioned towards the inside of the hoist on both lift arms.

Attach retaining pin to spindle.

Step 7

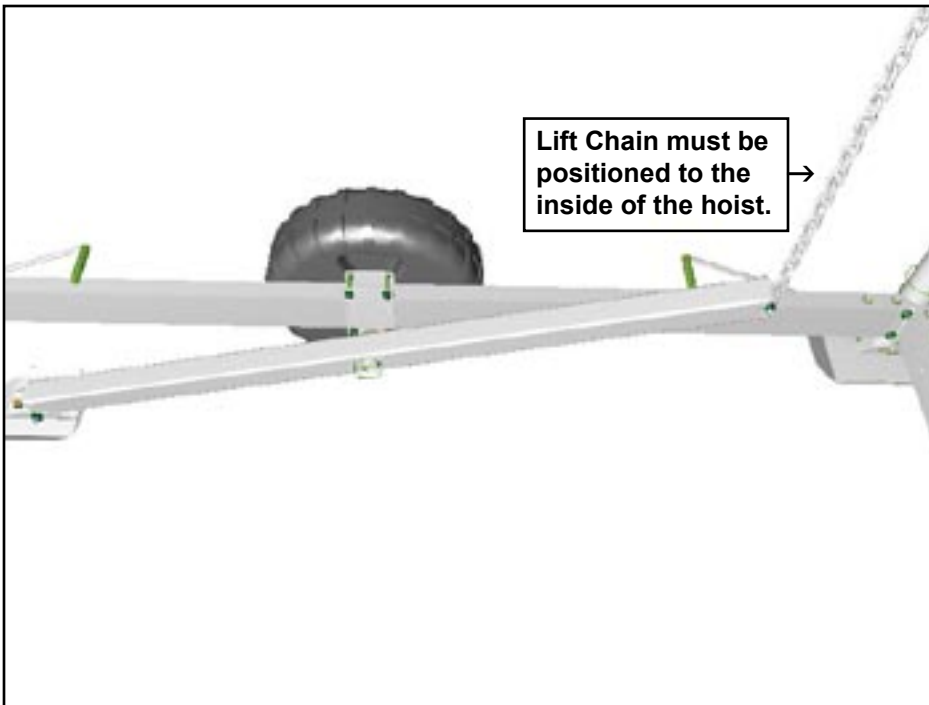

Repeat on opposite side of hoist.

NOTE: Lift chain should be positioned towards the inside of hoist.

Installation:

Step 1

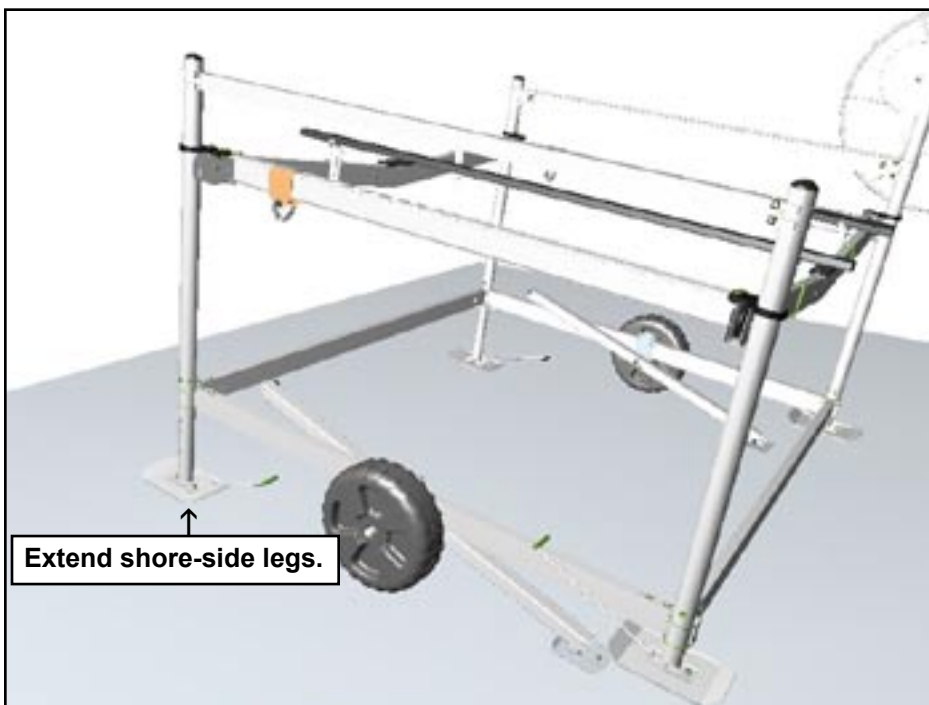

Once the lift arms are assembled to the spindles, rotate the tube until it is level with the lower frame. Wrap the lift chain around the lower frame to keep the base pad from contacting the ground.

Roll hoist to desired location.

Raise shore end of hoist up and adjust shore side adjustable legs to desired height.

Step 2

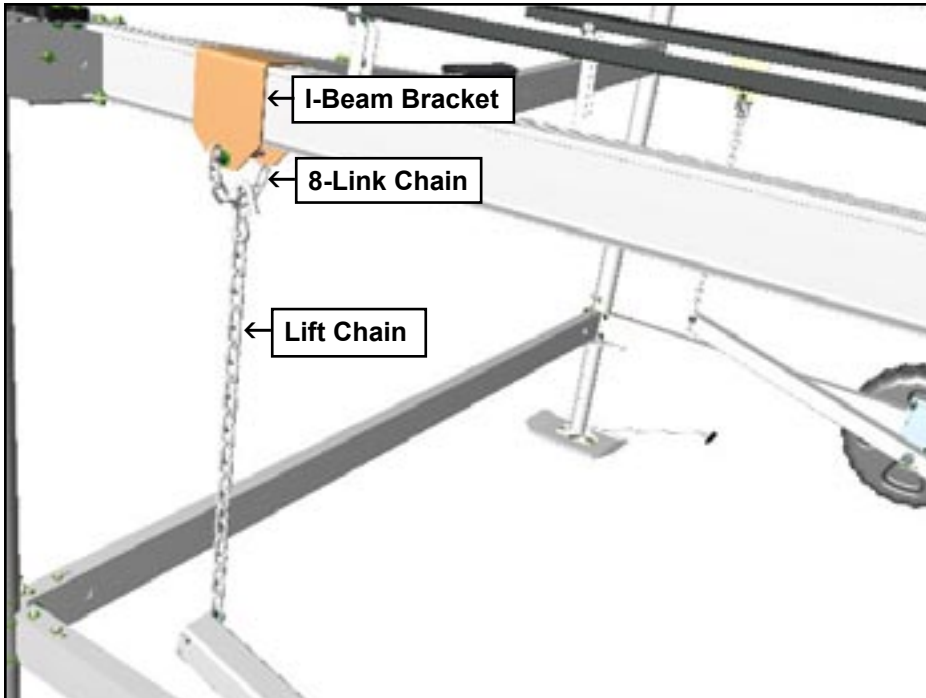

Lower hoist platform so lift chain hook can be slipped over the 8 link chain as shown. Position the I-beam bracket slightly closer to the center of the platform than what the chain connection point on the end of the tube is.

NOTE: Hook lift chain to 8-link chain only. Do NOT hook lift chain to bolt.

Step 3

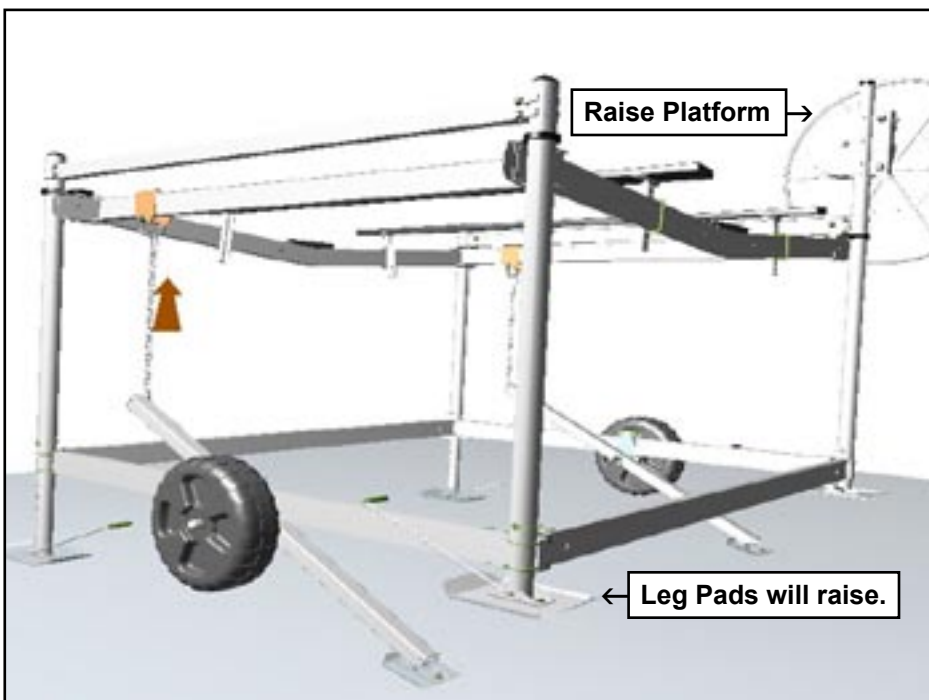

Raise hoist platform until lift arms have raised the rear of the hoist to the desired height.

Extend hoist leg pads and secure.

Lower platform until lift arms are no longer supporting the hoist. Disconnect lift chains.

For in place storage: Secure lift arms to lower frame by wrapping lift chain around arms and lower frame.

To store lift arms elsewhere: Remove retainer pins, lift arms and spacer bushings.

NOTE: No weight should rest on the wheels after installation. If water depth is not sufficient, remove wheels using the lift arms.

To remove the hoist from the water (reverse the process for installation):

- Lift the lake end of the hoist using lift arms
- Retract lake side legs
- Lower lift arms until hoist is resting on the wheels
- Retract shore-side legs
- Move hoist to desired location
- Lower legs so it is stored on legs, **not** wheels.

Adjustments



Lift arms can also be used to adjust both ends of the hoist for water level fluctuations by swapping lift arms from side to side. Slide the I-beam bracket towards the winch end of the platform. Keep the lift chain in line with I-beam bracket directly under platform.

HA0017 Elevator Arm Kit

ITEM	PART #	DESCRIPTION	QTY	NOTE
1	62550	SQUARE BASE PAD	1	
2	68946	CHAIN 1/4 (7MM) 8 LINK	1	
3	68949	CHANNEL - I-BEAM BRACKET	1	
4	68950	BUSHING - HOIST WHEEL SPACER	1	
5	68953	HOIST WHEEL TUBE	1	
6	0110038	HH 3/8-16 X 3/4 CS GR5	2	
7	0110064	HH 3/8-16 X 5 CS GR5	1	
8	0110114	HH 1/2-13 X 4 CS GR5	1	
9	0110118	HH 1/2-13 X 4 1/2 CS GR5	1	
10	1340095	WASHER USS FLAT 3/8	2	
11	1440101	HEX LOCKNUT FLANGE 3/8-16 W/T&T	3	
12	1440102	HEX LOCKNUT FLANGE 1/2-13 W/T&T	2	
13	2210301	CHAIN SAFETY 8/0 MACH X25LK W/LA	1	
14	3110381	PIN 1/4 X 2.5 GRIP LG W/SQ RET	1	
15	4850407	DECAL SAFE OPER. HOIST ROLL-IN	1	
16	A104	ALUM BASE PAD CHANNEL CLAMP	1	

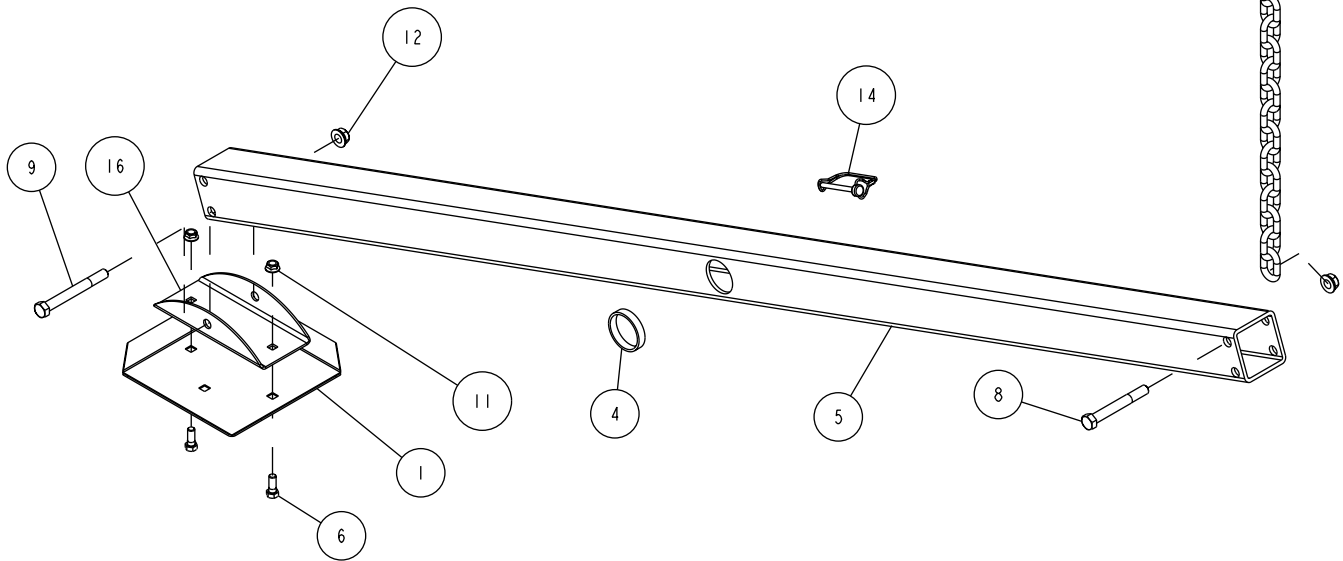
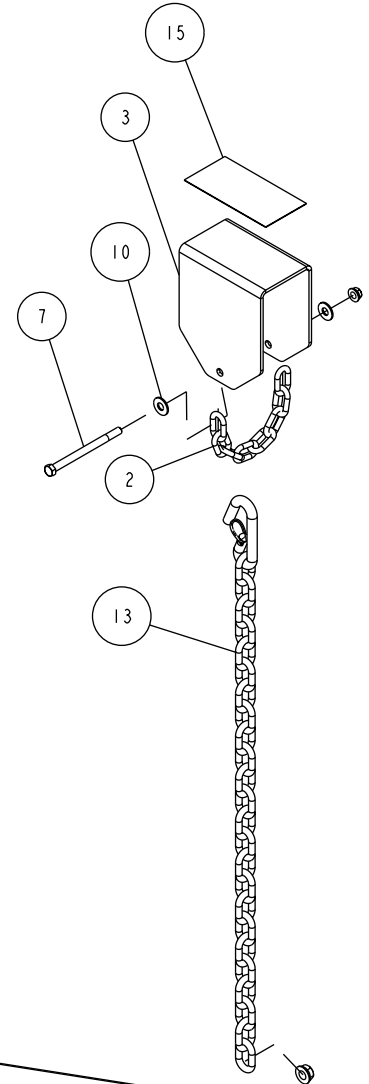

HA0018 Spindle Mounting Kit

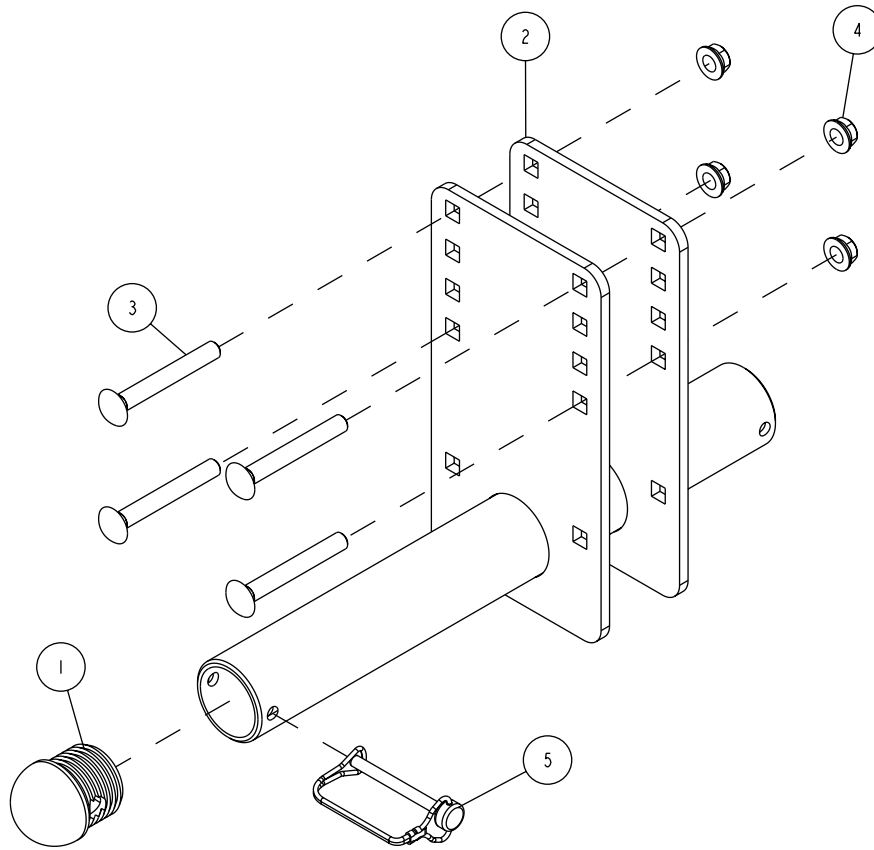

ITEM	PART #	DESCRIPTION	QTY	NOTE
1	68947	END CAP ROLLIN HOIST	1	
2	68951	HOIST WHEEL LEG WMENT	1	
3	0210128	CARR 3/8-16 X 3 GR5	4	
4	1440101	HEX LOCKNUT FLANGE 3/8-16 W/T&T	4	
5	3110381	PIN 1/4 X 2.5 GRIP LG W/SQ RET	1	