

1991

ShoreStation OWNERS MANUAL BOAT HOIST

SS1078-12 & SS1078-15

Bundles Required

SS1078-12

Qty	Bundle No.	Description
1	6114400	Yoke Tube Bundle
1	6114500	12 Ft. Bunk Bundle
1	6114600	Leg Bundle
1	6114700	Lower Frame Bundle
1	6114800	Lift Tube Bundle
1	6114900	Hardware Box
1	6115201	Lift Wheel Bundle

SS1078-15

Qty.	Bundle No.	Description
1	6114400	Yoke Tube Bundle
1	6115600	15 ft. Bunk Bundle
1	6114600	Leg Bundle
1	6114700	Lower Frame Bundle
1	6114800	Lift Tube Bundle
1	6114900	Hardware Box
1	6115201	Lift Wheel Bundle

1078 Assembly Instructions

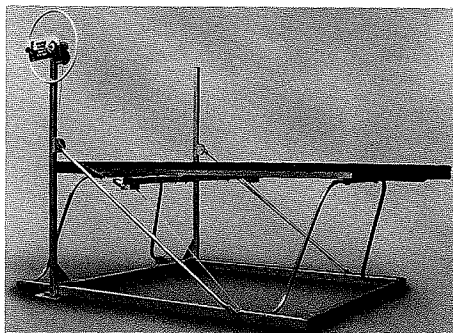

Please read all instructions prior to proceeding with assembly.

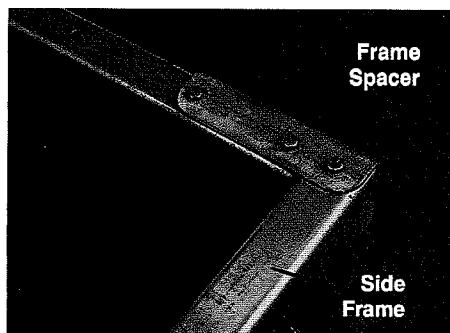

Assemble left and right side frame to frame spacer as shown with 3/8"x1" hex bolt and lock nuts.

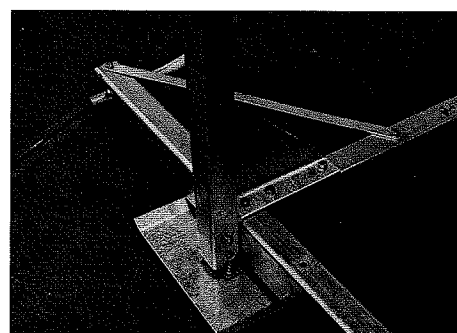

Assemble base pad on adjustable leg with 3/8"x3/4" machine bolt and hex lock nut and install in guide post. Secure adjusting leg with 3/8" pin and half pin. Install guide post to side frame and frame spacer as shown and secure with 3/8"x1" machine bolt and hex lock nut. Install angle lower frame brace strap as show.

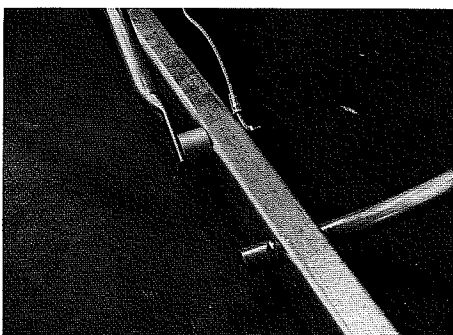

Install **inside** roll pin on all four yoke tube end. Install yoke tube in lower frame as shown. Install outside cotter keys. Install guide post brace, brace spacer 1/2"x2" O.D. and up limit cable as shown with 3/8"x5" machine bolt, (3/8" washer under hex lock nut) and hex lock nut. Repeat for other side.

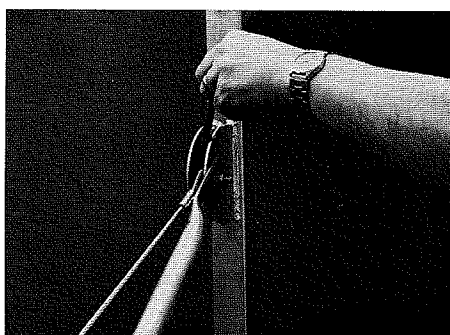

*Refer to Parts Page Ref. #27. Install **looped** end of winch cable on guide post opposite the winch. Position guide post brace on outside of guide post bracket. Secure guide post brace and cable end with 3/8"x2" machine bolt and hex lock nut. **Do not** overtighten.

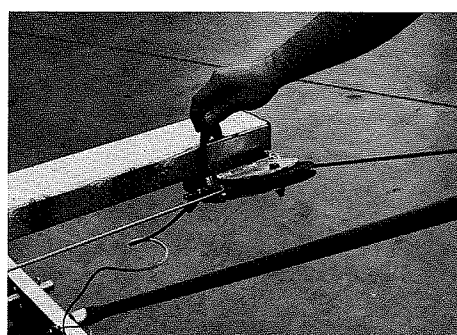

Lay winch tube on lower frame with pulley brackets **down**. Install pulley and bushing and secure with 3/8"x1 3/4" machine bolt and hex lock nut. Install pulley holder on winch tube and install 3/8"x6" from outside in and install up limit cable under 3/8" hex lock nut. Repeat for other end. Thread winch cable through winch tube pulleys.

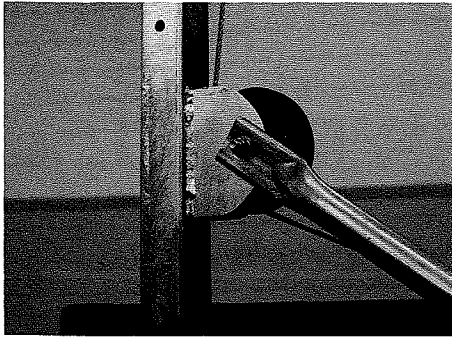

Install pulley and bushing and guide post brace on winch side as shown and secure with 3/8"x2" machine bolt and hex lock nut. Thread cable through pulley.

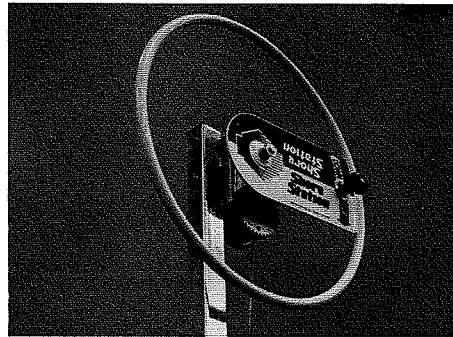

Install winch on winch post with 3/8"x2 3/4" machine bolt and hexlock nuts. Attach winch cable end to winch with special clip and 1/4" carriage bolt and hex nut. Thread wheel on winch and secure with shaft extension, spring, retainer washer and 5/16"x1 1/4" hex bolt. Install spinner knob on wheel.

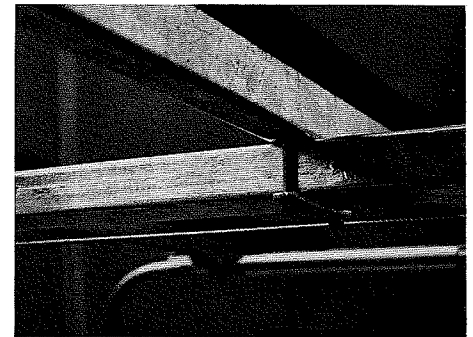

Lay out bunks as shown with **shortest** end (distance from center clamp to end) toward the winch end. Secure bunk to winch tube as shown with strap and hex nuts. Do not tighten at this time.

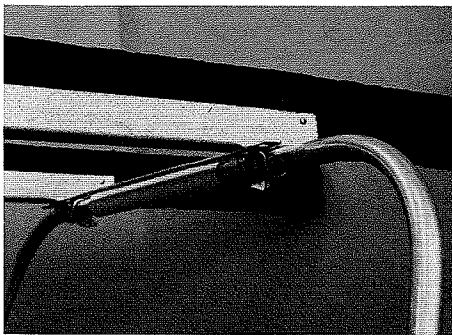

Install yoke tube clamps, 1 1/4" muffler style 1"x32" spreader bar as shown and secure with 3/8" hex nuts. Install plastic keel protector over yoke tube. Repeat for other end.

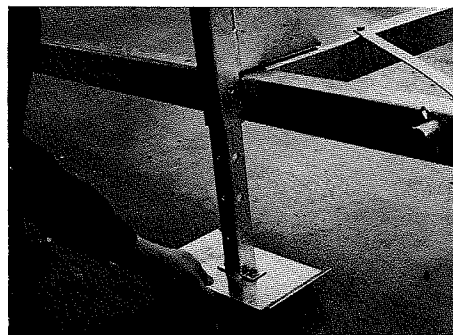

Adjustable legs on regular and optional guide posts extend approximately 12" or 5 holes of adjustment.

Assemble should be complete but **double check** all fasteners to insure that everything is secure and properly tightened.

SS1078-12 and SS1078-15 Boat Hoist

Ref. No.	Part No.	Description	Qty.	Ref. No.	Part No.	Description	Qty.
1	S-4014	12' bunk	2	29	3510085	4 1/2" nylatron sleeve	3
--	61154	15' bunk	2	--	4810720	black and white lift wheel decal	1
2	S-547	2"x4" SL plastic end cap	2	--	4810745	1000# cap. and caution decal	2
3	B613	leg pin	2	30	61113	back cross member insert	2
4	B639	2"x2" plastic cap	2	31	61115	upright brace	2
5	0110038	3/8"x3/4" hex bolt	4	32	61117	yoke tube - 1078 hoist	2
6	0110048	3/8"x2" hex bolt	2	33	61121	lower frame crossmember	2
7	0110066	3/8"x5 1/2" hex bolt	2	34	61123	bunk channel 12'	2
8	0110069	3/8"x6 1/2" hex bolt	2	--	61155	bunk channel 15'	2
9	0110064	3/8"x5" hex bolt	2	35	61124	side frame channel	2
10	0140040	3/8"x1" hex bolt	16	36	61125	lower frame corner bracket, right	1
11	0140047	3/8"x1 3/4" hex bolt	2	37	61126	yoke pivot bracket	4
12	0210100	3/8"x3/4" carriage bolt	8	38	61127	adjustable leg	2
13	0210126	3/8"x2 3/4" carriage bolt	4	39	61129	bunk support plate	2
14	0210128	3/8"x3" carriage bolt	1	40	61131	leg base pad	2
15	0310055	1 1/8" saddle clamp u-bolt	4	41	61140	lower frame corner bracket, left	1
16	0810920	#10x1 1/4" phil pan head	16	42	6120300	corner strap	2
17	1310180	1 13/16" ODx7 ga tapped washer	1	43	6113000	lift tube strap	2
18	1340095	3/8" flat washer	5	44	6113200	pulley holder bracket	2
19	1410079	5/16" lock nut	8	45	6113400	lift tube	1
20	1410109	3/8" finished hex nut	1	46	6113600	upright post, left	1
21	1440101	3/8" flange lock nut	42	47	6113700	upright post, right	1
22	1510121	5/16"x 2 1/4" cotter key	4	48	6113901	lift wheel	1
23	1540035	1/8"x1" cotter key	4	49	61142	stop cable	2
24	1540300	#7 hitch pin clip	2	50	61143	lift cable	1
25	1540450	5/16"x2 1/2" roll pin	4	51	6119700	bunk spacer strap	2
26	1940030	1 1/8" clamp saddle	4	52	6120210	steel bushing	3
27	3110207	B1200 brake winch	1	53	61207	aluminum spacer	2
28	3510001	blue spinner plastic knob	1				

***Winch #27 can be install on either guide post. Simply reverse the cable/pulley installation procedure.**

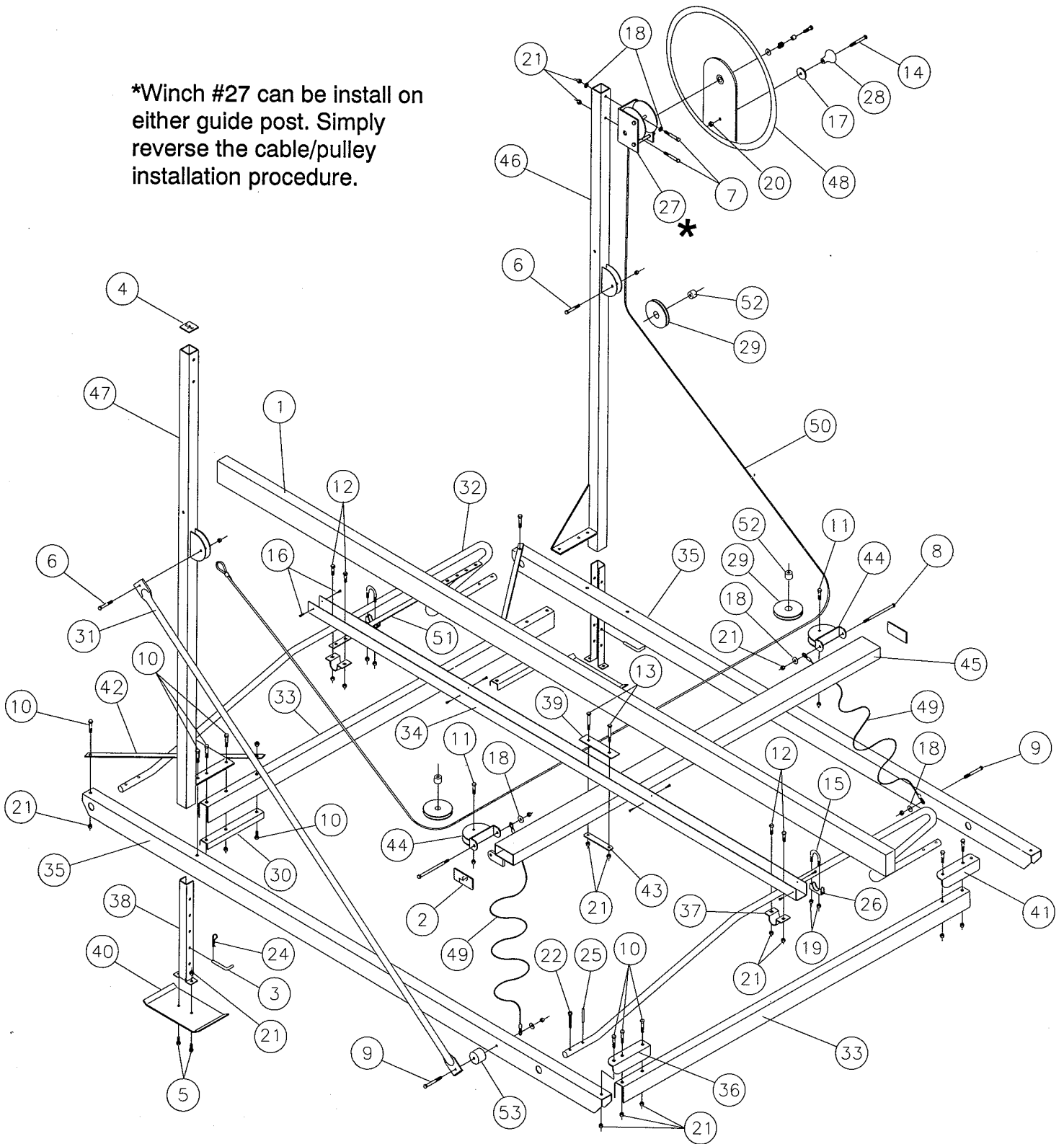



If for some reason the winch clutching mechanism fails and the winch handle begins to spin uncontrollably, never attempt to stop it. To do so may result in bodily injury.

NEVER lower the hoist platform to its lowest position when it is on dry land and there is a boat on it. To do so may result in damage to the lower frame.

**Before operating hoist, perform the following check on the winch mechanism.
Maximum Capacity of this Hoist is 1,000 lbs.**

CHECKING THE WINCH MERCHANTISM

After the hoist installation is complete, it is important to next check and see that the winch mechanism is functioning properly. This is easily accomplished by raising the empty platform about one-fourth the way up and releasing your grasp on the crank handle. If winch is operating properly, clutch brake will automatically hold platform at any position. Perform this same test in the half, three-fourths, and full lift positions. Next, repeat this same procedure in the water with your boat on the hoist. If the crank handle begins to freely spin down from any of these test positions, at no time should you attempt to prevent it from doing so. Such action could result in bodily injury. Instead, simply let the platform spin down into the water. Doing so will neither damage your hoist nor your boat.

If for some reason your winch mechanism does not function as described, call your authorized Shore-Station dealer. Do not tamper with winch mechanism.

SAFETY TIPS

“THE BEST INSURANCE POLICY IS SAFETY”

- 1. See to it that you, your family, and anyone else who uses the hoist does not look upon the unit as a toy, but a piece of heavy equipment that deserves your respect and good judgment.**
- 2. Before allowing anyone to operate the unit, be sure they fully understand the proper operating procedure.**
- 3. Do not exceed the maximum capacity of your unit; overloading may cause mechanical failure and serious personal injury.**
- 4. If you choose to remove the winch for inspection or repairs, be sure the platform is completely lowered. Never manipulate any of the winch mechanisms when the platform is raised.**
- 5. Do not allow passengers to board your craft when it is raised on your hoist.**
- 6. It is a good safety policy to restrict children, as well as adults, from playing on or near the hoist.**
- 7. When hoist is unattended we strongly recommend you padlock it to protect both you and your equipment.**
- 8. Be sure to pull the drain plug before leaving for any length of time. A few good rain storms could push your gross weight over the hoist capacity.**
- 9. When positioning the boat on platform before raising, be sure the lower unit of the motor is not more than 2' from the platform.**
- 10. Front-end boat stop and centering devices function best when platform is lowered just enough to float craft easily off the rack.**
- 11. Check cable periodically for fraying. If this occurs, replace cable immediately.**
- 12. Be sure hoist is installed level, severe out of level installation may cause hoist hang up and serious personal injury.**
- 13. Do not work on your boat when it is on the hoist.**

**NOTE: Parts breakdown on third page.
Refer to this when ordering repair parts.**

**MIDWEST INDUSTRIES, INC.
IDA GROVE, IOWA 51445 TEL (712) 364-3365**