

SSV60120 HYD ShoreStation Aluminum V-Frame Hydraulic Hoist Parts Manual

Your **ShoreStation** Hydraulic Boat Hoist is designed to give years of dependable service. Following the instructions in the operator's manual will insure its dependability and more important, **YOUR** safety. Read through this entire operator's manual before attempting to operate your hoist. Our goal is your safety - help us help you by knowing and observing the operating precautions and limitations you will find listed herein. If you do not understand any of these instructions, please ask your dealer for his personal attention to your questions.

Midwest Industries, Inc.
Ida Grove, IA 51445

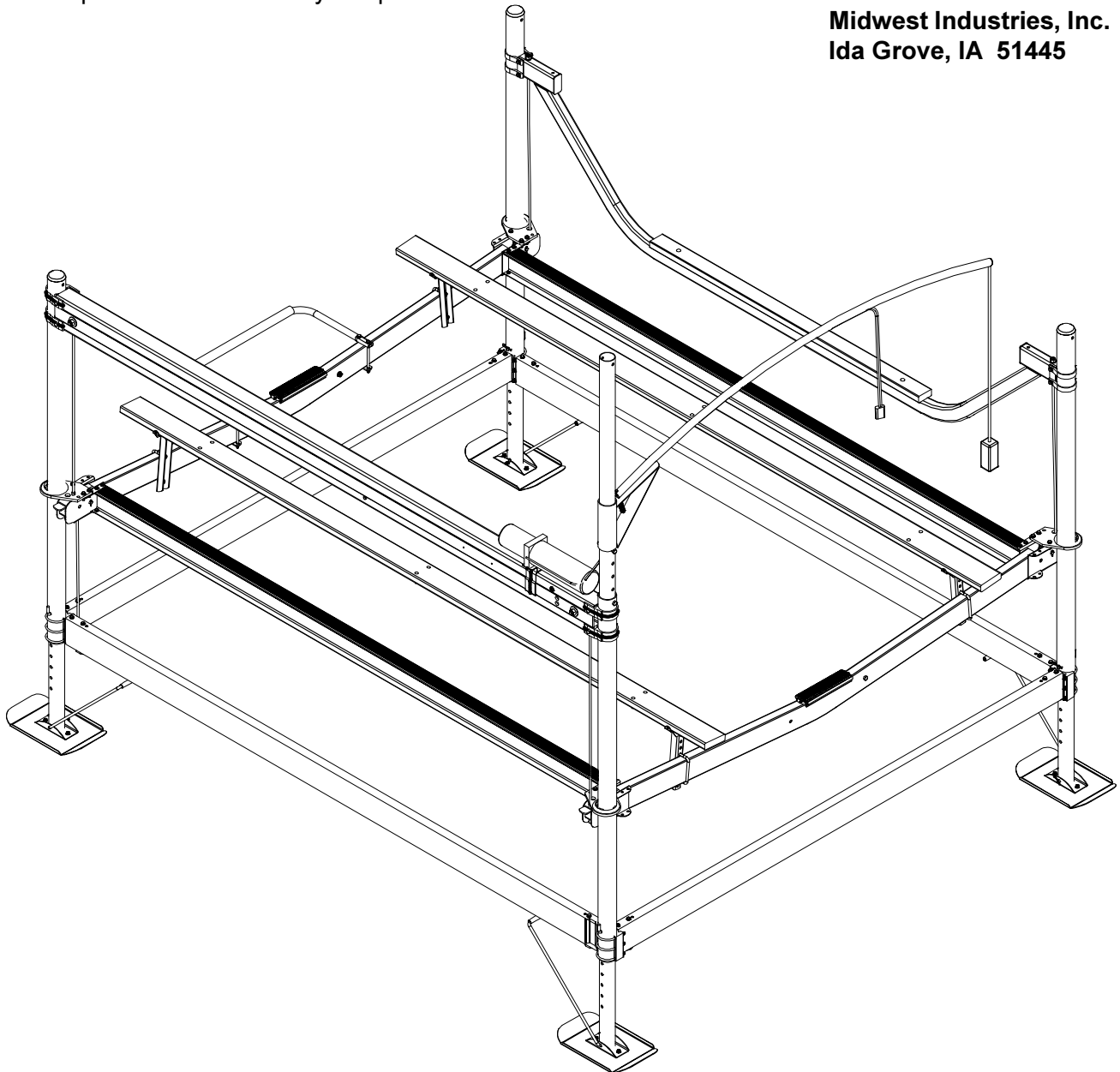

SSV60120 HYD Bundles

66556	Drop Side Bundle HYD V60120
66604	Bunk Bundle HYD 60120
66606	Platform Bundle HYD 60120
66607	Winch Tube Bundle HYD 60120
66608	Hydraulic Pump Assy HYD Hoist
SS1204	Control Arm Assy
66676	Leg Bundle SSV60120 HYD
66678	Hdwe Box V60120 HYD
66689	Lower Frame Bundle V60120 HYD

Tools Required for Assembly

9/16" Socket / Wrench
3/4" Socket / Wrench
5/16" Socket / Wrench
7/16" Socket / Wrench
Wire Threader

SAFETY PRECAUTIONS

DO NOT OPERATE THIS HOIST WITHOUT FIRST STUDYING THIS OWNER'S MANUAL

1. See to it that you, your family, and anyone else who uses the hoist looks upon the unit not as a toy, but a piece of heavy equipment that deserves your respect and good judgment.
2. Before allowing anyone to operate the unit, be sure they fully understand the proper operating procedure.
3. Do not exceed maximum capacity of unit, overloading may cause mechanical failure and serious personal injury.
4. All persons should stand clear and should not be allowed to board your watercraft when it is being raised or lowered.
5. If you choose to remove the pump cover and inspect or work on the pump, be sure the platform is completely lowered.
6. It is a good safety policy to restrict children, as well as adults, from playing on or near the hoist.
7. Service pump annually. **IMPORTANT:** Pump maintenance schedule must be followed to avoid possible failure and injury.
8. Check cable for wear or fraying and also stress on cable attaching ends. If this occurs, replace cable immediately.
9. Be sure the hoist is installed level, severe out of level installation may cause hoist hang up and serious personal injury.
10. Do not work on your watercraft or hoist with watercraft on the hoist.
11. Check all sheaves, make sure they are turning and operating properly.
12. Check fasteners on cable ends to be positive they are threaded properly (see setting up instructions).
13. If the platform begins to fall down for any reason, at no time should you attempt to prevent it from doing so. Such action could result in injury to arms and hands. Instead, simply let the platform fall down into the water. Doing so will neither damage your watercraft or hoist.
14. Never pick up on platform of hoist while trying to move, position, or transport hoist. Doing so may cause serious personal injury.
15. Never stand or walk on hoist platform while in any raised position. Doing so may cause serious personal injury.

SAFETY MAINTENANCE

It is recommended that your ShoreStation hoist be thoroughly inspected at least once each season:

1. Tighten all bolts.
2. Check pulleys and make sure they are all turning freely.
3. Inspect all cables for fraying, wearing or deteriorating. If any signs appear, replace cables.
4. Check frame thoroughly.
5. Check pump as per manufacturer's specifications.

SSV60120 HYD Lower Frame

REF#	PART#	DESCRIPTION	QTY
1	A103	ALUM BASE PAD	4
2	A104	ALUM BASE PAD CHANNEL CLAMP	4
3	A389	BLACK PLASTIC CAP	3
4	A126	BOTTOM CORNER CABLE BRKT	2
5	A315	ADJUSTMENT LEG	4
6	0210100	CARR 3/8-16 X 3/4 GR5	8
7	1440101	FLANGE LOCKNUT SMALL 3/8-16	48
8	3510014	GRIP-BLACK PLASTIC - 1/2" ID X 4 1/2 ..	4
9	A354	GUIDE POST 3 1/2"OD X 84"	4
10	1440269	HEX NUT FINISH 5/8-11 GRB	4
11	0110069	HH 3/8-16 X 6 1/2 CS GR5	12
12	0110070	HH 3/8-16 X7 CS GR5	4
13	1540300	HITCH PIN CLIP #7	8
14	A135	LEG ADJUSTMENT PIN	4
15	A141	LEG LIFT ROD(BOAT LIFT)	4
16	A302	LOWER CORNER BLOCK 5 11/16	4
17	62689	LOWER FRAME TUBE 6 X 2 X 119IN	2
18	66688	LOWER FRAME TUBE 6 X 2 X 143IN	2
19	0310097	RUB 3/8" X 3 7/8 X 4 5/8	12
20	1340095	WASHER USS FLAT 3/8	16
21	1340105	WASHER USS FLAT 5/8	2

Assemble the base pad clamps (Ref.#2) to the base pads (Ref.#1) with 3/8" X 3/4" carriage bolts (Ref.#6) and 3/8" flange lock nuts (Ref.#7) on all four (4) pads. Tighten.

Place the black grips (Ref.#8) on the four (4) leg lift rods (Ref.#15).

Mount the base pads to the adjustable legs (Ref.#5) with the leg lift rods (Ref.#15) in the bottom hole and secure with the hitch pin clips (Ref.#13). **NOTE:** The leg lift rods must clear the lower corner blocks (Ref.#16).

Note that the guide posts (Ref.#9) are factory-assembled with corner blocks (Ref.#16), 3/8" X 3-7/8" X 4-5/8" round u-bolts (Ref.#19) and 3/8" flange lock nuts.

The guide posts and adjustable leg can be adjusted to the water height - use the leg adjustment pins (Ref.#14) to level the hoist. Secure with hitch pin clips.

Slide the lower frame tubes (Ref.#17 & 18) onto the corner blocks. **NOTE: The drop side weldment is always facing the dock side of hoist. The pump will be lake side. This will determine the right and left side of the hoist. Refer to drawing for placement.** The 119" lower frame tubes (Ref.#17) are the frame spacers for width. The 143" lower frame tubes (Ref.#18) are the side frame.

NOTICE: The guide post tubes with red vinyl dots attached are to be used with the winch tube assembly positioned to lakeside of the hoist.

Secure the lower frame to guide post using 3/8" X 6-1/2" hex bolts (Ref.#11) (3/8" flat washers to the head of bolt) nearest the guide posts. Tighten with 3/8" flange lock nuts. Attach the bottom corner cable bracket (Ref.#4) to the under side of lower frame tubes using 3/8" X 7" hex bolts (Ref.#12) (3/8" flat washers to the head of bolt) matching the hole pattern on the bottom corner cable bracket. Secure with 3/8" flange lock nuts.

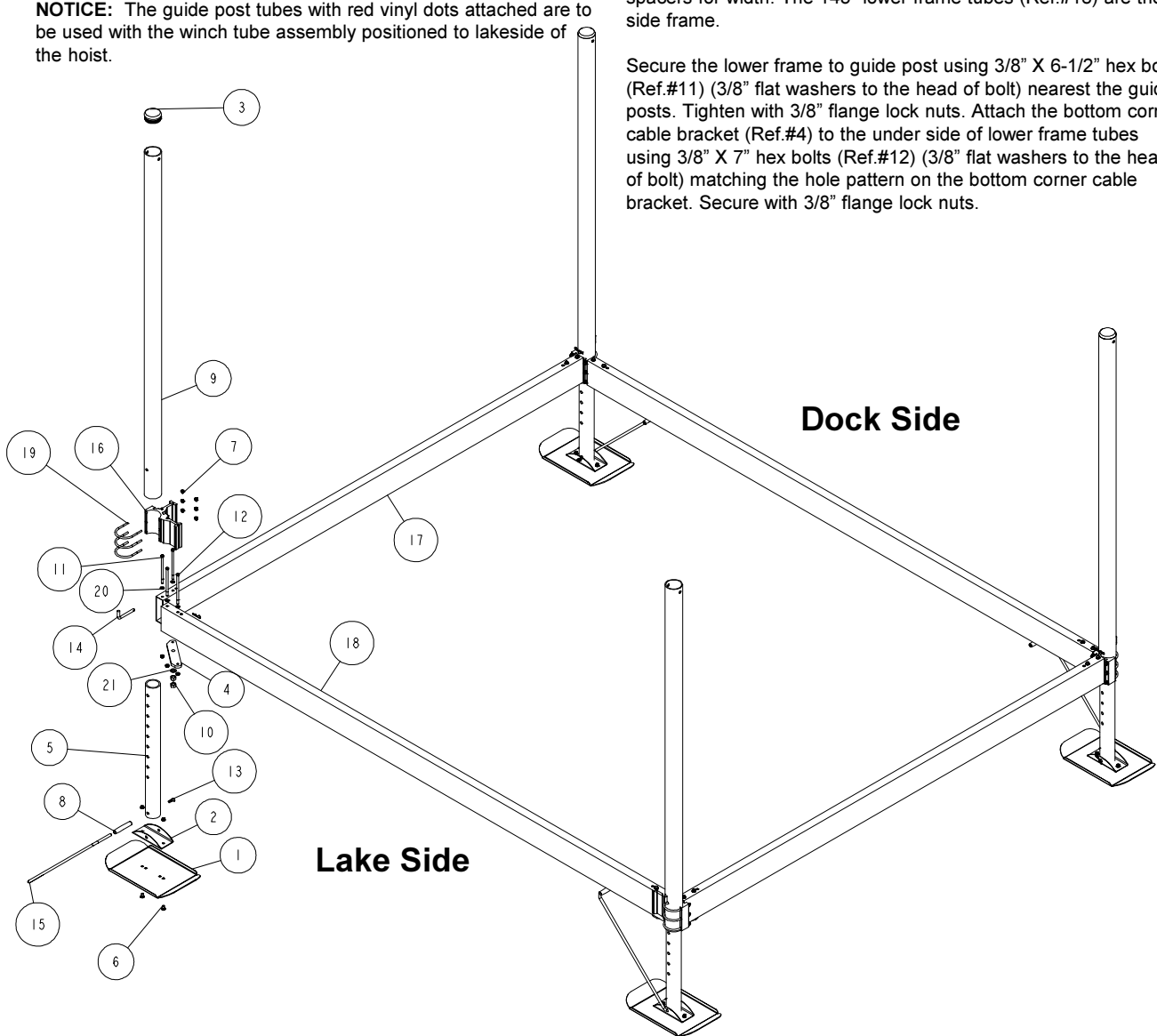

SSV60120 HYD Platform

REF#	PART#	DESCRIPTION	QTY
1	S-3179G	2X6 BUNK BRKT SPUN GALV.	4
2	65064	ADJ BUNK BRKT. (BOAT LIFT)	4
3	3510132	AXLE PAD 12IN BLK	2
4	66549	BUNK ASSY W/BRKTS & STIFFENER	2
5	61047	BUNK SUPPORT FOR V55132 HOIST	2
6	3910025	BUNKWOOD 2 X 6 X 14FT FIR	2
7	3510099	BUSHING - NYLATRON V-HOIST	2
8	60989	BUSHING SS STEEL (BOAT LIFT)	2
9	64052	CABLE RETAINER CHANNEL-V FRAME 4	
10	3110361	CABLE STAINLESS STEEL LEVEL	1
11	3110361	CABLE STAINLESS STEEL LEVEL	1
12	A119	CORNER GUIDE W/POLY RING	2
13	A120	CORNER GUIDE W/POLY RING	2
14	1510078	COTTER KEY 3/16 X 1	8
15	63062	CRADLE TUBE WMENT 120	2
16	0210060	ELEVATOR BOLT 1/4-20 X 2 1/4, GR2	12
17	1440102	FLANGE LOCKNUT SMALL 1/2-13	2
18	1440101	FLANGE LOCKNUT SMALL 3/8-16	20
19	1410079	HEX LOCKNUT 5/16-18 GRA	16
20	1440159	HEX NUT FINISH 1/2-13	8
21	1410049	HEX NUT FINISH 1/4-20	12
22	1440269	HEX NUT FINISH 5/8-11 GRB	4
23	0110098	HH 1/2-13 X 2 1/2 CS GR5	2
24	0140045	HH 3/8-16 X 1 1/2 CS GR5	12
25	0140040	HH 3/8-16 X 1 CS GR5	4
26	0110070	HH 3/8-16 X7 CS GR5	4
27	0140022	HH 5/16-18 X 3/4 CS GR5	16
28	60991	KEEL PROTECTOR PLATE(BOAT LIFT) . 2	
29	1310040	LOCKWASHER 1/2 S/T MED	8
30	1310020	LOCKWASHER 1/4 S/T MED	12
31	3510033	MOTOR STOP PLASTIC TUBE	1

Place the cradle tube weldments (Ref.#15) onto the lower frame.
NOTE: The cables (Ref.#11) that lay over the top of the pulley and then come out the bottom of the cradle tube weldment must be positioned on the pump side of hoist.

Place the cable end down through the hole in the cable mounting bracket on the determined winch tube side of hoist. Secure with a 5/8" flat washer (Ref.#40) and two (2) 5/8" hex nuts (Ref.#22). Turn on the first nut then turn on the second nut with a wrench, turn first nut counterclockwise with another wrench until the two (2) nuts are locked together securely. Repeat cable tightening procedure on the other cradle tube weldment at the opposite end of the hoist.

Install the platform I-beam (Ref.#34) to the cradle tube weldments using 5/16" X 3/4" hex bolts (Ref.#27). **NOTE:** The 5/16" flat washer should be positioned next to the aluminum to protect aluminum from gouging and at the head of the 5/16" X 3/4" hex bolt. Secure with 5/16" flat washers (Ref.#41) and 5/16" hex lock nuts (Ref.#19). Place two (2) 5/16" bolts in each of the top and bottom flange on the platform I-beam. Repeat on all four (4) corners and tighten.

Slide the corner guide rings (Ref.#12 & 13) over the guide posts with the round edge of the nylon insert up. **IMPORTANT:** The round edge must be up on all four (4) corner guide rings.

Match the bolt patterns on the corner guide ring and the cradle tube weldment flange. Insert 3/8" X 1-1/2" hex bolt (Ref.#27) with 3/8" flat washers (Ref.#41) at the bolts head and secure with 3/8" flange lock nuts. Repeat on all four (4) corners. Center the total platform on the lower frame. Position the corner guide ring on the guide post so the ring is centered and that there is 1/16" to 1/8" clearance on the inside of the corner guide ring and the guide post. Tighten all bolts. Repeat this process on all four (4) corners.

Determine which end of the hoist you will be driving your boat in from. Once determined, mount one (1) motor stop bracket (Ref.#32) to the cradle tube weldment with two (2) 3/8" X 7" hex

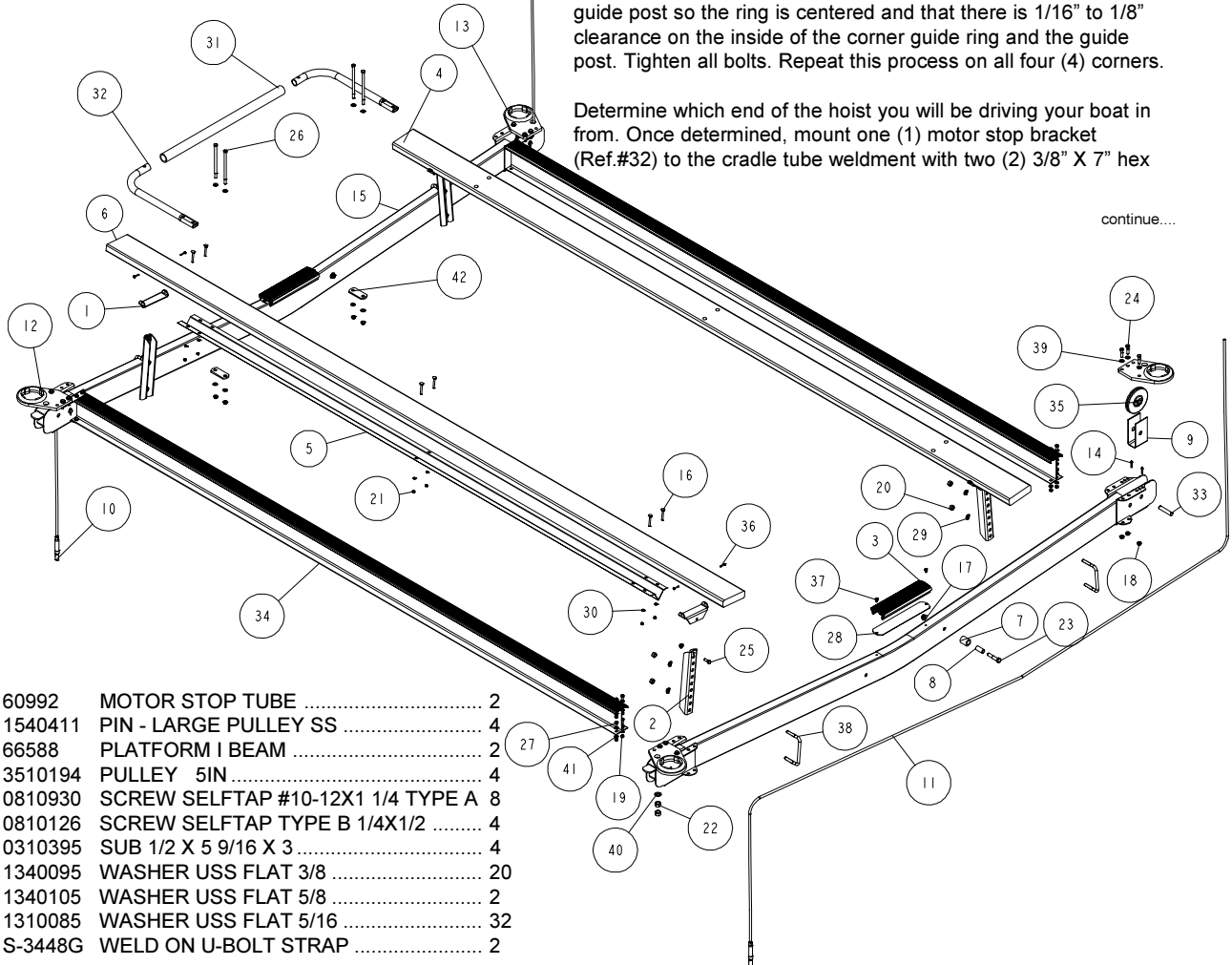

continue...

32	60992	MOTOR STOP TUBE	2
33	1540411	PIN - LARGE PULLEY SS	4
34	66588	PLATFORM I BEAM	2
35	3510194	PULLEY 5IN	4
36	0810930	SCREW SELFTAP #10-12X1 1/4 TYPE A 8	
37	0810126	SCREW SELFTAP TYPE B 1/4X1/2	4
38	0310395	SUB 1/2 X 5 9/16 X 3	4
39	1340095	WASHER USS FLAT 3/8	20
40	1340105	WASHER USS FLAT 5/8	2
41	1310085	WASHER USS FLAT 5/16	32
42	S-3448G	WELD ON U-BOLT STRAP	2

continued from...

bolts (Ref.#26), 3/8" flat washers, mounting strap (Ref.#42), 3/8" flat washer and 3/8" lock nuts. Tighten only finger tight. Slip the 30" plastic tube (Ref.#31) over the end of the motor stop bracket into the other end of the 30" plastic tube. Secure to the cradle tube weldment with 3/8" X 7" hex bolts, 3/8" flat washer on top and bottom and 3/8" hex lock nuts. Locate the motor stop brackets so that it is in the center of the cradle tube weldment and tighten.

Place a 1/2" X 5-9/16" X 3" u-bolt over the cradle tube weldment so that the legs of the u-bolt are pointing to the center of the hoist.

Place an adjustable bunk bracket over the u-bolt legs in an adjustment location that would best fit your water craft. Secure with two (2) 1/2" lock washers and 1/2" hex nuts. Repeat on the other side of the cradle tube weldment making sure that the u-bolts are all pointing to the center of the hoist to allow clearance for the lower frame.

Mount the bunk assemblies to the adjustable bunk brackets using 3/8" X 1" hex bolt and 3/8" flange lock nuts. Do not over tighten. The bunk assembly must pivot so that the bunks conform to the hull of your watercraft.

SSV60120 HYD Winch Tube

REF#	PART#	DESCRIPTION	QTY	REF#	PART#	DESCRIPTION	QTY
1	3510228	6 1/2 DIA. SHEAVE	3	16	3210102	HOSE 20" 1/4-18 MP-4JIC FE SW 90	1
2	3210103	ADAPTOR 90 DEG MALE 1/4NPT-6ORIN	2	17	3210102	HOSE 20" 1/4-18 MP-4JIC FE SW 90	1
3	3210100	ADAPTOR STR THD 4 JIC-4 ORING	2	18	3210073	HYDRAULIC 1/4 IN FEMALE COUPLER .	2
4	3210097	BOBALEE 2.5: HYDRAULIC ASSEMBLY .	1	19	3210071	HYDRAULIC 1/4 IN MALE COUPLER	2
5	3110362	CABLE LIFT SSV60120 HYD	1	20	3210096	HYDRAULIC PUMP/MOTOR	1
6	3110363	CABLE WINCH SSV60120 HYD	1	21	1340030	LOCKWASHER 3/8 S/T MED	2
7	1440102	FLANGE LOCKNUT SMALL 1/2-13	4	22	3820075	MERCURY SWITCH HOUSING	1
8	1440101	FLANGE LOCKNUT SMALL 3/8-16	1	23	66589	MOTOR MOUNT BRKT	1
9	3510030	GROMMET 7/8IN MOLDED	1	24	1540407	ROLL PIN - 1/8 X 1/2"	4
10	1420309	HEX NUT 3/4-16 UNF	2	25	1540418	ROLL PIN - 3/16 X 1 1/4"	1
11	0110125	HH 1/2-13 X 5 1/2 CS GR5	4	26	3610161	STAINLESS STEEL BUSHING-1.6875	1
12	0110316	HH 1/4-20 X 1/2 CS FULL THREADED	2	27	3610158	STAINLESS STEEL BUSHING-3 19/32	1
13	0110285	HH 3/4-10 X 5 1/2 CS GR5	2	28	66603	TOP CLAMP - WINCH TUBE	4
14	0110038	HH 3/8-16 X 3/4 CS GR5	2	29	1310120	WASHER USS FLAT 3/4 ULTRASEALED	4
15	0110062	HH 3/8-16 X 4 1/2 CS GR5	1	30	66587	WINCH TUBE - 6 5/8 TALL	1

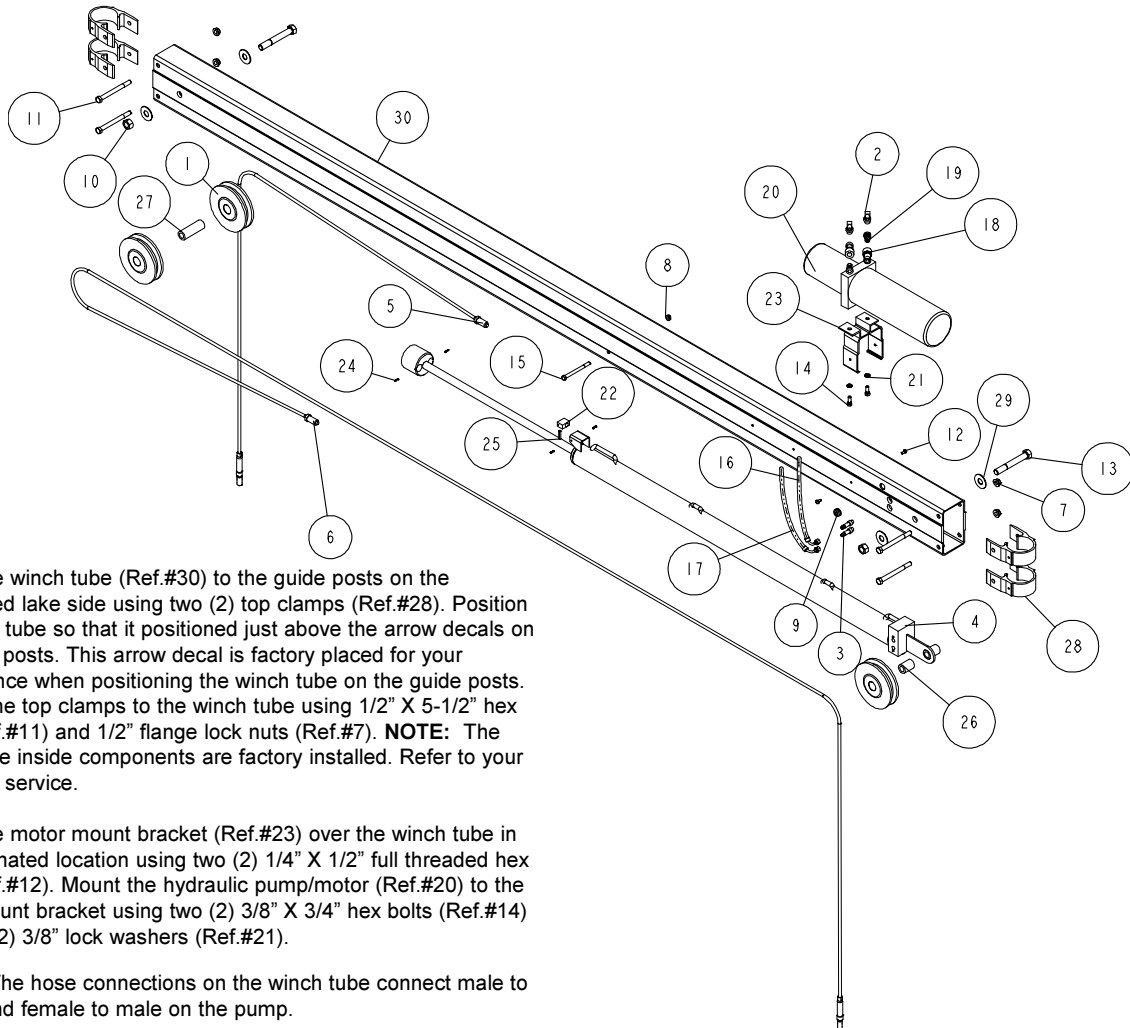

Mount the winch tube (Ref.#30) to the guide posts on the determined lake side using two (2) top clamps (Ref.#28). Position the winch tube so that it is positioned just above the arrow decals on the guide posts. This arrow decal is factory placed for your convenience when positioning the winch tube on the guide posts. Tighten the top clamps to the winch tube using 1/2" X 5-1/2" hex bolts (Ref.#11) and 1/2" flange lock nuts (Ref.#7). **NOTE:** The winch tube inside components are factory installed. Refer to your dealer for service.

Mount the motor mount bracket (Ref.#23) over the winch tube in the designated location using two (2) 1/4" X 1/2" full threaded hex bolts (Ref.#12). Mount the hydraulic pump/motor (Ref.#20) to the motor mount bracket using two (2) 3/8" X 3/4" hex bolts (Ref.#14) and two (2) 3/8" lock washers (Ref.#21).

NOTE: The hose connections on the winch tube connect male to female and female to male on the pump.

SSV60120 HYD Hoist Pump Wiring Diagram

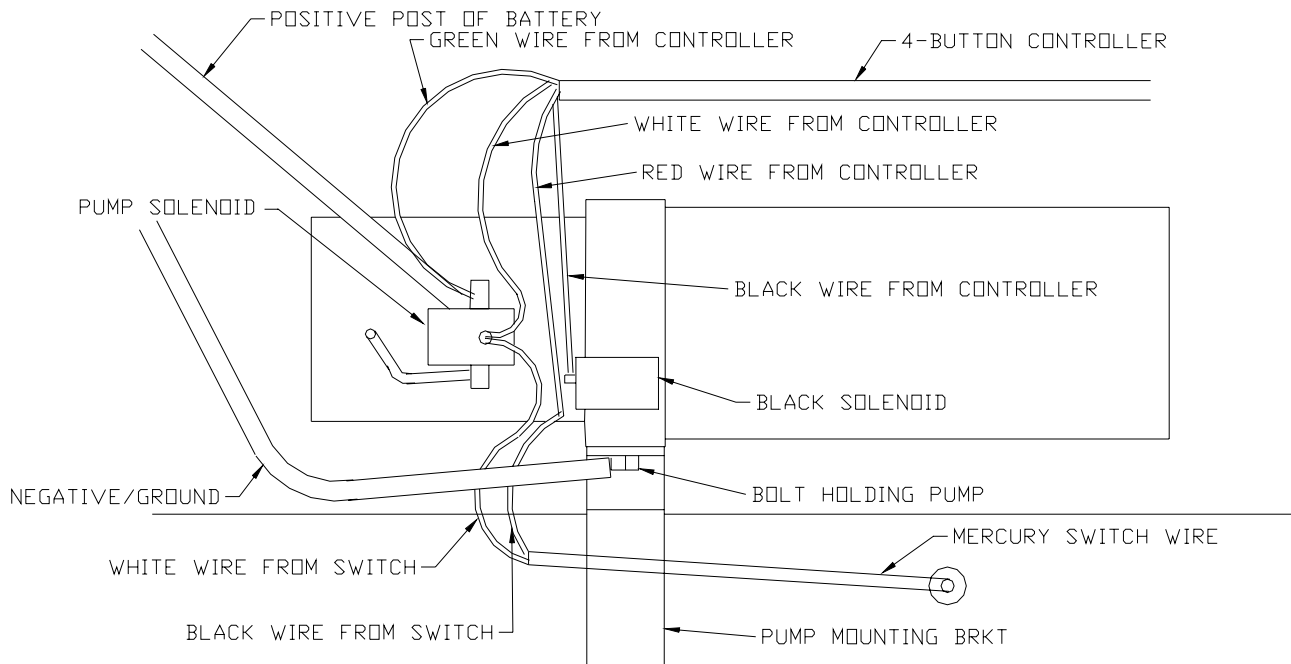

Trouble Shooting

General:

1. Check to see that the motor is wired correctly with tight connections, and for the proper voltage.
2. Check reservoir oil level.
3. Check for external leakage at cylinders, hoses and power unit.

Typical Examples

Symptom	Possible Cause	Fixes & Hints
Unit will not start (See causes 1,2,3 & 10)	1. Improper voltage to motor. (A, F & G)	A. Check wiring and insure connections are tight, as well as proper voltage.
Unit drifts with power unit off. (See causes 5,6,7 & 8)	2. Improper ground. (A, H & I)	B. Keep oil reservoir full & clean.
Slow cylinder travel. (See causes 1,2,3,7,8,9,10 & 11)	3. Relief valve set too low. (C & E)	C. Do not adjust valves without the proper equipment (pressure-gauge).
Unit will not lower. (See causes 2,4,5 & 11)	4. Relief valve set too high. (C & E)	D. Flush & clean hydraulic system.
	5. Improper voltage to valve solenoid. (A & H)	E. Adjust relief valve to proper setting.
	6. Leakage through pump check valve. (D & F)	F. Replace component.
	7. Leakage through solenoid lowering valve. (D & F)	G. Return for necessary repair.
	8. Internal leakage at cylinder. (F & G)	H. Check for clean tight metal to metal chassis ground.
	9. Insufficient oil to pump. (B, D & G)	I. Make sure nut is tight on solenoid valve 15 in LB max.
	10. Pump seized - frozen up. (F & G)	
	11. Cylinder overloaded. (C & E)	

SSV60120 HYD Winch Tube Cable Diagram

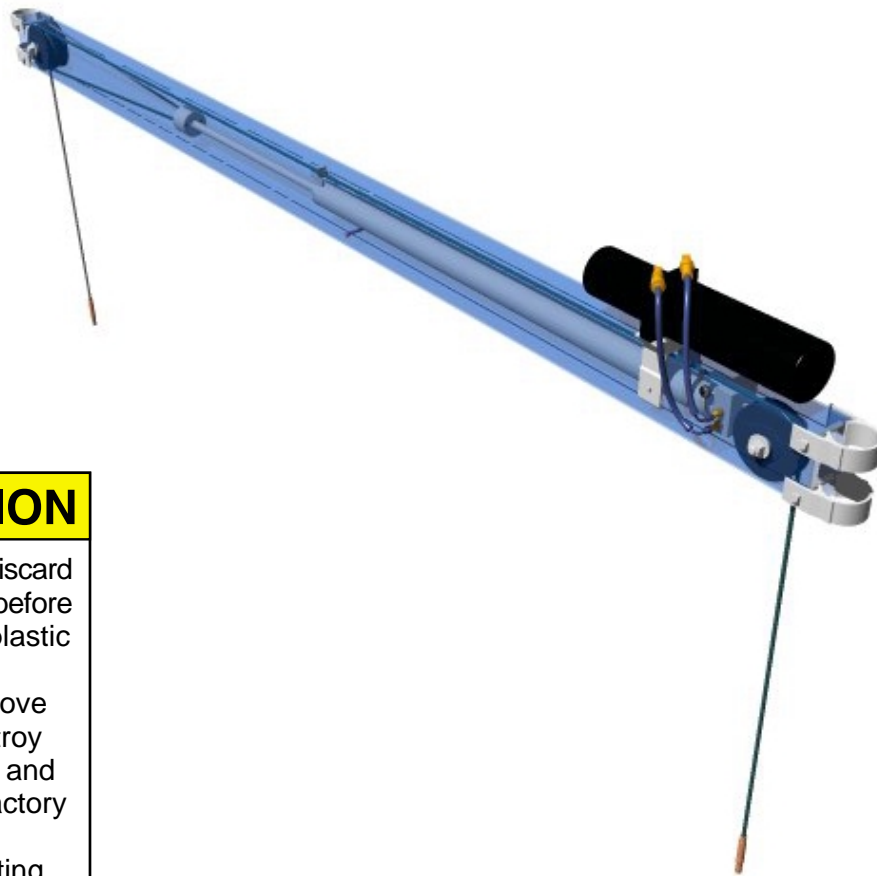
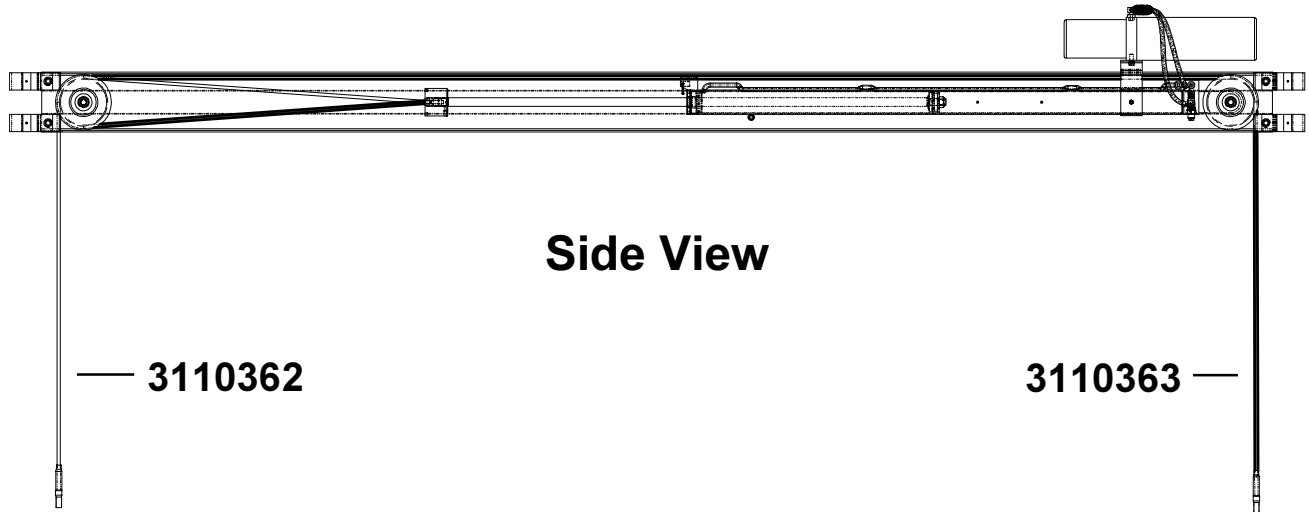

CAUTION

Remove and discard 3/8" pipe plug before using. Insert plastic breather cap. Failure to remove plug may destroy gasket. Pump and cylinder are factory filled with oil. Normal operating level with hoist in raised position is 2" from top.

4850385

SSV60120 HYD Drop Side

REF#	PART#	DESCRIPTION	QTY
1	66555	BUNK W/CARPET FOR HYD V60120	1
2	0210137	CARR 3/8-16 X 5 FULL THREAD GR5	2
3	66592	CLAMP/SHIM HYD V60120	4
4	66556	DROP SIDE BUNDLE FOR HYD 60120 ...	1
5	66554	DROP SIDE WMENT HYD V60120	1
6	1440101	FLANGE LOCKNUT SMALL 3/8-16	4
7	1410109	HEX NUT FINISH 3/8-16	2
8	1440269	HEX NUT FINISH 5/8-11 GRB	2
9	0110058	HH 3/8-16 X 3 1/2 CS GR5	4
10	1340030	LOCKWASHER 3/8 S/T MED	2
11	S-547	SL END CAP	2
12	65937	TOP CLAMP 1IN WITH 2 3/8 OPENING ..	4
13	1340095	WASHER USS FLAT 3/8	4
14	1340105	WASHER USS FLAT 5/8	2

Mount the drop side weldment (Ref.#5) to the guide posts on the determined dock side using four (4) top clamps (Ref.#12). Position the drop side weldment so that it positioned just above the arrow decals on the guide posts. This arrow decal is factory placed for your convenience when positioning the drop side weldment on the guide posts. Tighten the top clamps with clamp/shims (Ref.#3) to the drop side weldment and guide posts using 3/8" X 3-1/2" hex bolts (Ref.#9), 3/8" flat washer (Ref.#13) and 3/8" flange lock nuts (Ref.#6).

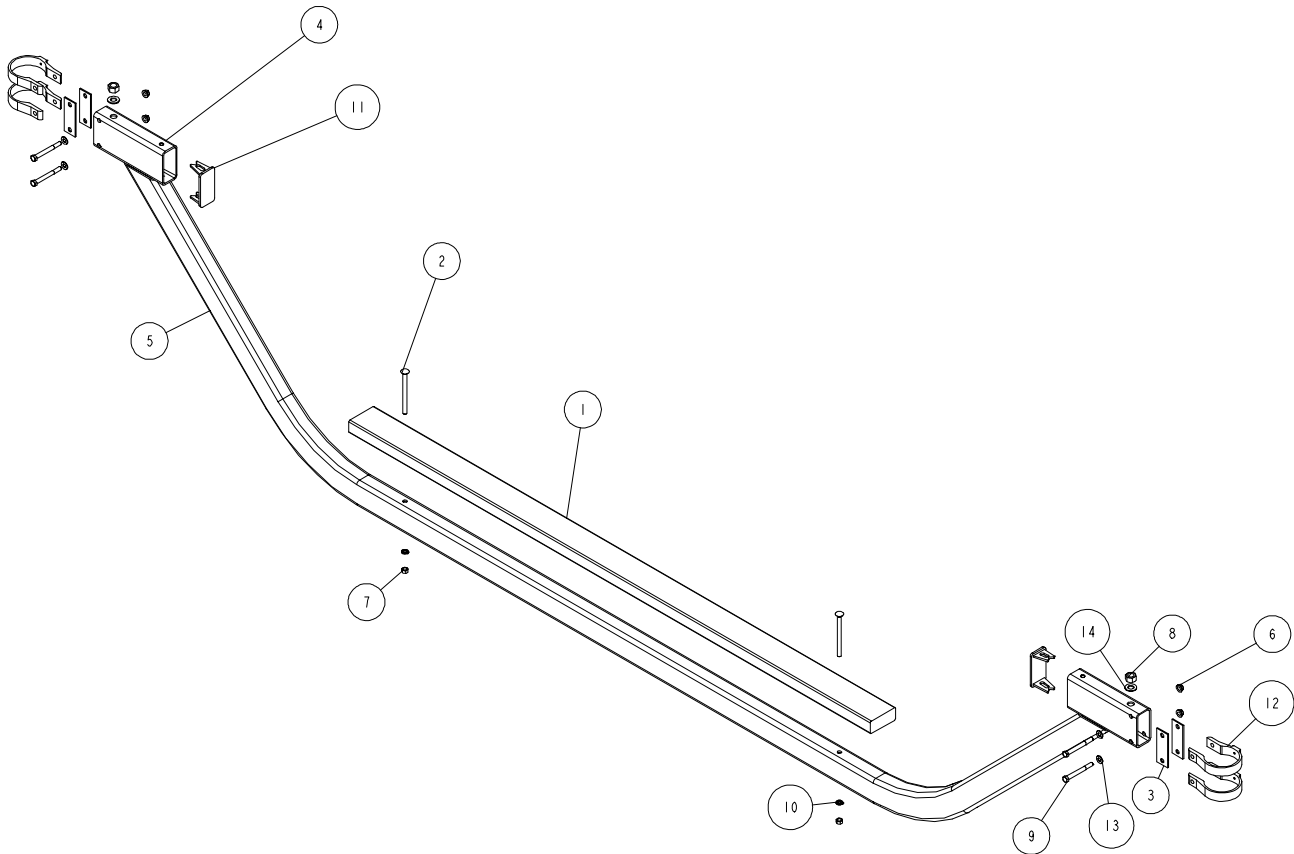

SSV60120 HYD Control Arm

SS1204 Control Arm Assembly for Hydraulic Hoists

REF#	PART#	DESCRIPTION	QTY
1	3510229	BUSHING W/FLANGES, BLK PLASTIC ...	1
2	66852	CANOPY/CONTROLLER LEG TUBE 60 ...	1
3	0210051	CARR 1/4-20 X 2 1/4 GR5	1
4	66596	CONTROL ARM PIVOT WMENT	1
5	66597	CONTROL ARM TUBE	1
6	66859	CONTROLLER LOCKOUT ASSY	1
7	5310223	CONTROLLER W/CABLE	1
8	1440102	FLANGE LOCKNUT SMALL 1/2-13	3
9	1410049	HEX NUT FINISH 1/4-20	2
10	0110114	HH 1/2-13 X 4 CS GR5	3
11	0110315	HH 1/4-20 X 6 CS GR5 ZP	1
12	3210104	HOSE 5/8 ID HEATER 6 FT	1
13	2121227	SPRING COMP .9375OD X 4 X .148	1
14	A209	SUPPORT CUP WITH 3 1/2 OD TUBE	1
15	1310070	WASHER USS FLAT 1/4	1
16	1340095	WASHER USS FLAT 3/8	1

Slide the black bushing with flanges (Ref.#1) in the end of the control arm and thread the control cable (Ref.#6) through the tube.

Slide the 72" extension leg (Ref.#2) into the guide post nearest to the hydraulic pump/motor on lake side of hoist. Secure with a 1/2" X 4" hex bolts (Ref.#9) and 1/2" flange lock nuts (Ref.#7) in an adjustment holes for desired height.

Slide the control arm weldment assembly (Ref.# 4 & 5) over the extension leg just installed. This assembly will rest on the top 1/2" X 4" hex bolt just installed. The control arm weldment assembly must be able to swivel freely.

Connect the controller with cable to the hydraulic pump/motor.

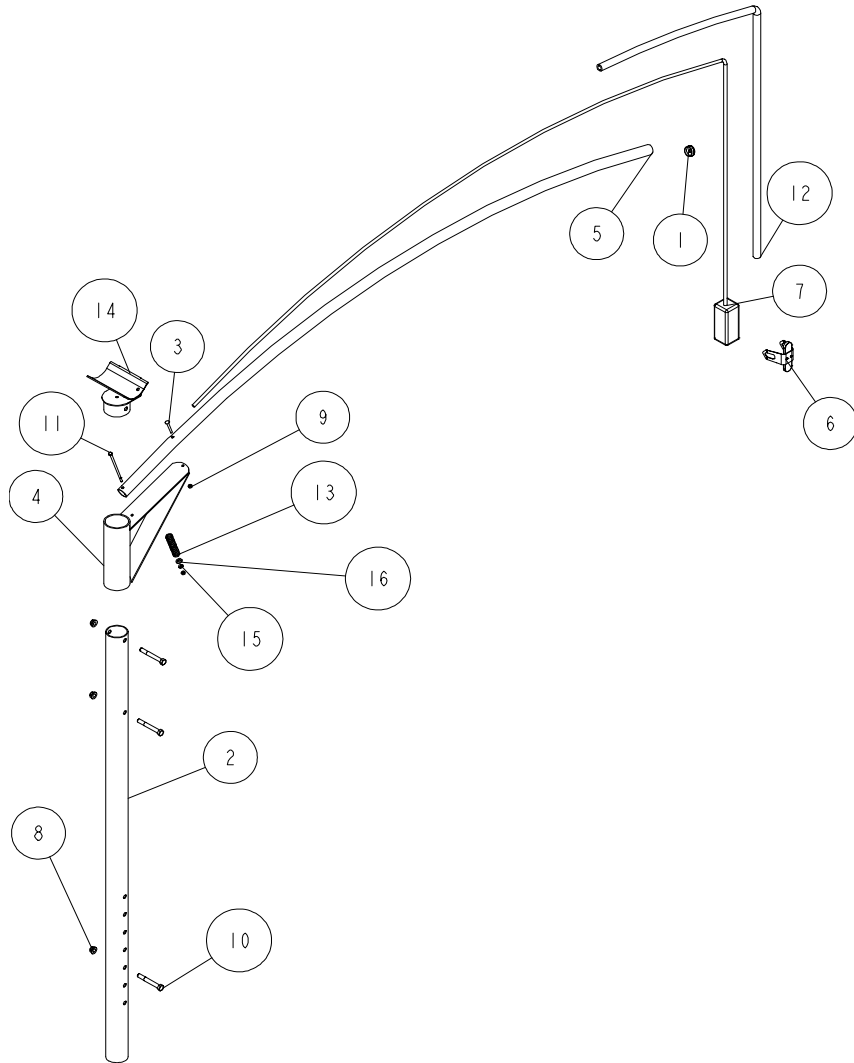

SSV60120 HYD Loadguide - Optional

SS1196 Loadguides - SSV60120 HYD

REF#	PART#	DESCRIPTION	QTY
1	66627	BUNK LOADGUIDE HYD V60120	2
2	3510227	END CAP LOAF LOADGUIDE	4
3	62406	FENDER SUPPORT BRKT	4
	1440101	FLANGE LOCKNUT SMALL 3/8-16	28
5	0140045	HH 3/8-16 X 1 1/2 CS GR5	8
6	0110037	HH 3/8-16 X 1 1/4 CS GR5	4
7	66629	LOADGUIDE ADJ ARM HYD V60120	4
8	66626	LOADGUIDE EXTRUSION HYD V60120 ..	2
9	66628	LOADGUIDE MTG BRKT HYD V60120	4
10	0810919	SCREW SELFTAP TYPE A #10X2 1/2 P ..	10
11	0810920	SCREW SELFTAP TYPE A #10X1 1	10
12	S-3449G	SPRING AND AXLE U-BOLT PLATE	4
13	0310109	SUB 3/8 X 2 7/16 X 6 1/2	8

Move the loadguide adjustment arm (Ref.#7) on the bunk loadguide assembly (Ref.#1 & 8) in a downward position.

Assemble the bunk loadguide assembly to the loadguide mounting brackets (Ref.#9) in the desired height location using two (2) 3/8" X 1-1/2" hex bolts (Ref.#5) and two (2) 3/8" flange lock nuts.

Determine the distance between guide post to where you want to position the loadguide assembly and mark. Attach the loadguide assembly to the platform using 3/8" X 2-7/16" X 6-1/2" square u-bolts over the loadguide mounting bracket and through the spring u-bolt plate. Secure with 3/8" flange lock nuts.

Tighten all flange lock nuts.

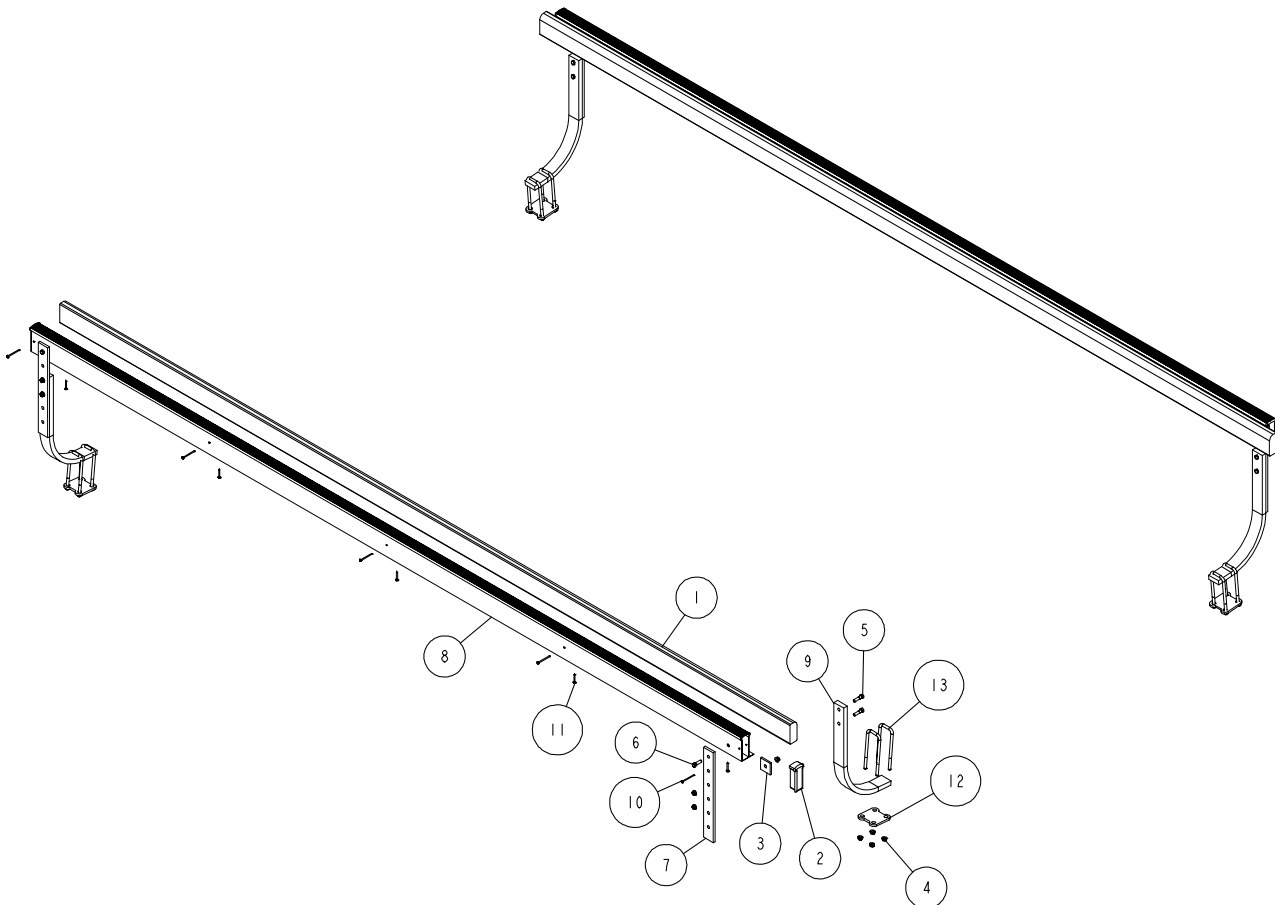

Adjustable Step - Optional

SS1202 Adjustable Step - Hydraulic Hoist

REF#	PART#	DESCRIPTION	QTY
1	0210125	CARR 3/8-16 X 2 1/2 GR5	4
2	1410109	HEX NUT FINISH 3/8-16	8
3	1340030	LOCKWASHER 3/8 S/T MED	8
4	66845	STEP BRKT FOR HYD HOIST	2
5	66844	STEP BUNK FOR HYD HOIST	1
6	0310108	SUB 3/8-16 X 3 7/16 X 3	2

Remove the existing bunk assembly on the drop side weldment.

Mount the step brackets (Ref.#4) to the step bunk (Ref.#5) using four (4) 3/8" X 2-1/2" carriage bolts (Ref.#1) down through the step bunk and step brackets. Secure with 3/8" lock washers (Ref.#3) and 3/8" hex nuts (Ref.#2).

Determine the location on the drop side weldment that you would mount this assembly and mark. Attach the step assembly to the drop side weldment using two (2) 3/8" X 3-7/16" X 3" square u-bolts (Ref.#6) and secure with 3/8" lock washers and 3/8" hex nuts.

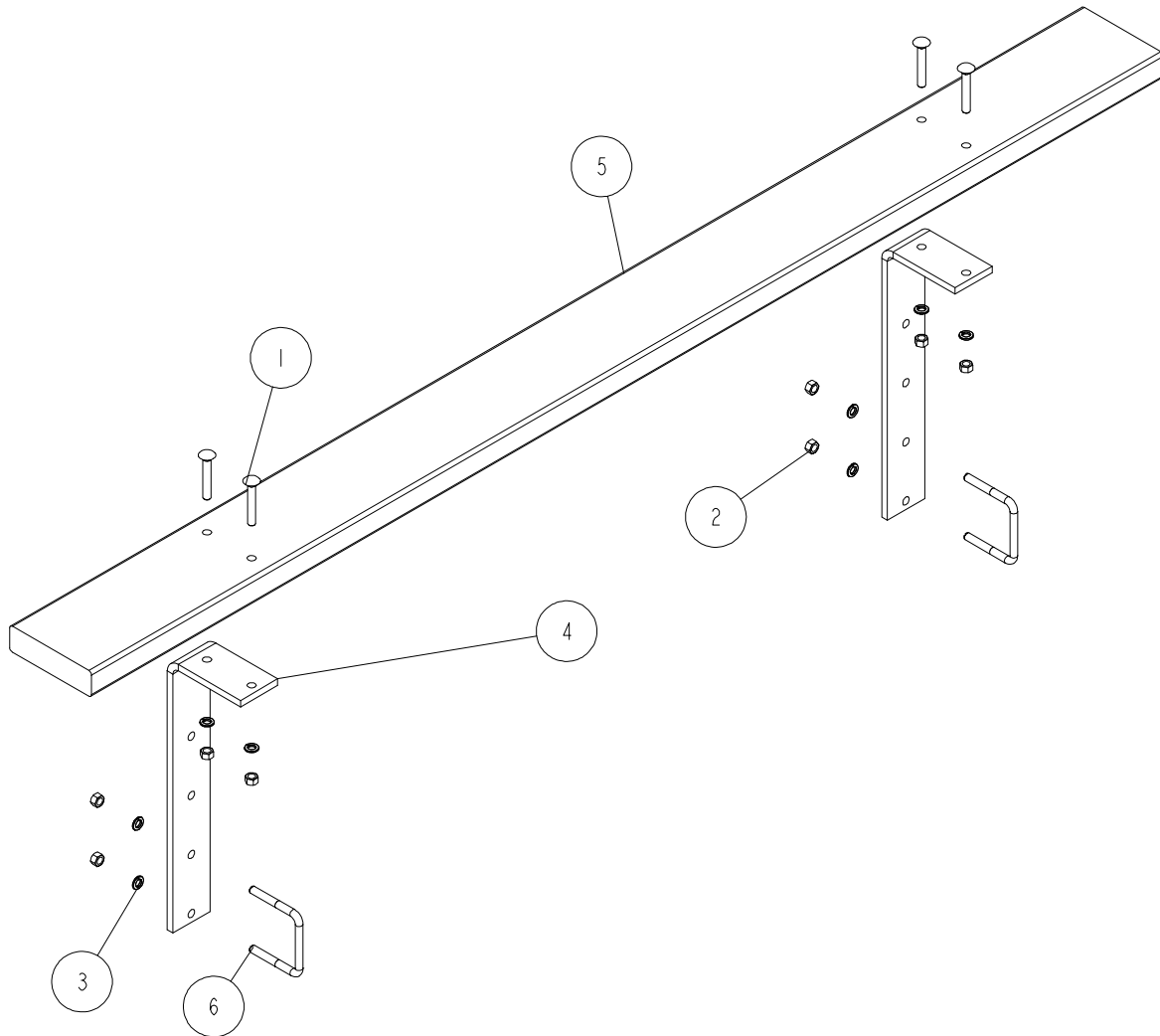

Battery Mounting Hardware - Optional

SS1203 Battery Mounting Hardware - Hydraulic Hoist

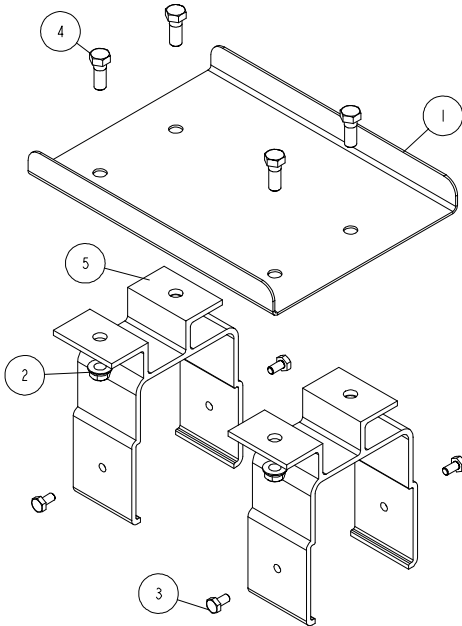

REF#	PART#	DESCRIPTION	QTY
1	66590	BATTERY HOLDER BRKT	1
2	1440101	FLANGE LOCKNUT SMALL 3/8-16	4
3	0110316	HH 1/4-20 X 1/2 CS FULL THREADED	4
4	0110038	HH 3/8-16 X 3/4 CS GR5	4
5	66589	MOTOR MOUNT BRKT	2

Mount the motor mounting bracket (Ref#5) to the winch tube in the designated holes using four (4) 1/4" X 1/2" full threaded hex bolts (Ref.#3).

Mount the battery holder bracket (Ref.#1) to the motor mounting brackets using four (4) 3/8" X 3/4" hex bolts (Ref.#4). Secure with 3/8" flange lock nuts (Ref.#2).

Canopy Pendant Holder - Optional

SS1205 Canopy Pendant Holder - Hydraulic Hoist

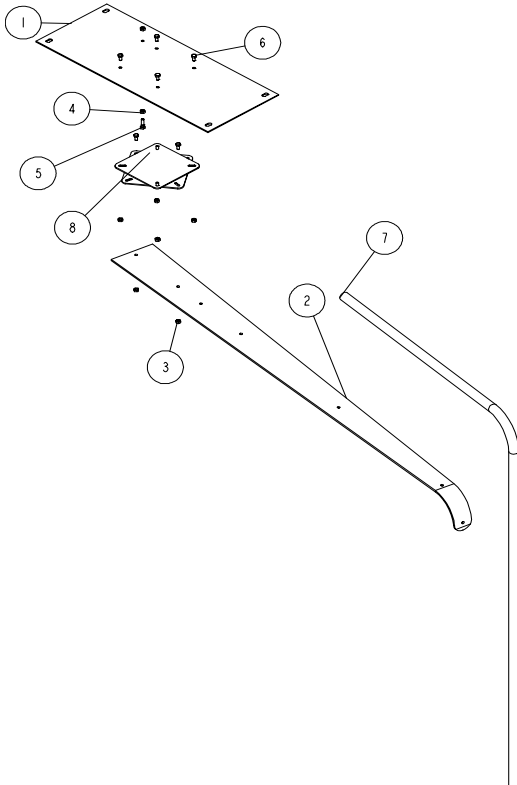

REF#	PART#	DESCRIPTION	QTY
1	66841	CANOPY PENDANT BRACKET	1
2	66842	CONTROLLER SWING ARM	1
3	1410059	HEX LOCKNUT 1/4-20 GRA	6
4	1410049	HEX NUT FINISH 1/4-20	2
5	0110021	HH 1/4-20 X 1 1/2 CS GR5	1
6	0110316	HH 1/4-20 X 1/2 CS FULL THREADED	6
7	3210104	HOSE 5/8 ID HEATER 6 FT	1
8	2400008	SWIVEL - ZINC PLATED	1
-	1110036	WIRE TIE 4 IN BLACK	4

Place the canopy pendant bracket assembly under the bows of the canopy frame in the center nearest to the hydraulic pump/motor. Secure the pendant bracket to the bows of the canopy frame using four (4) 1-3/4" hose clamps.

Run the controller cable along the side of the controller swing arm. Secure the controller cable to the controller swing arm using five (5) black wire ties.

SSV60120 HYD Decal Placement

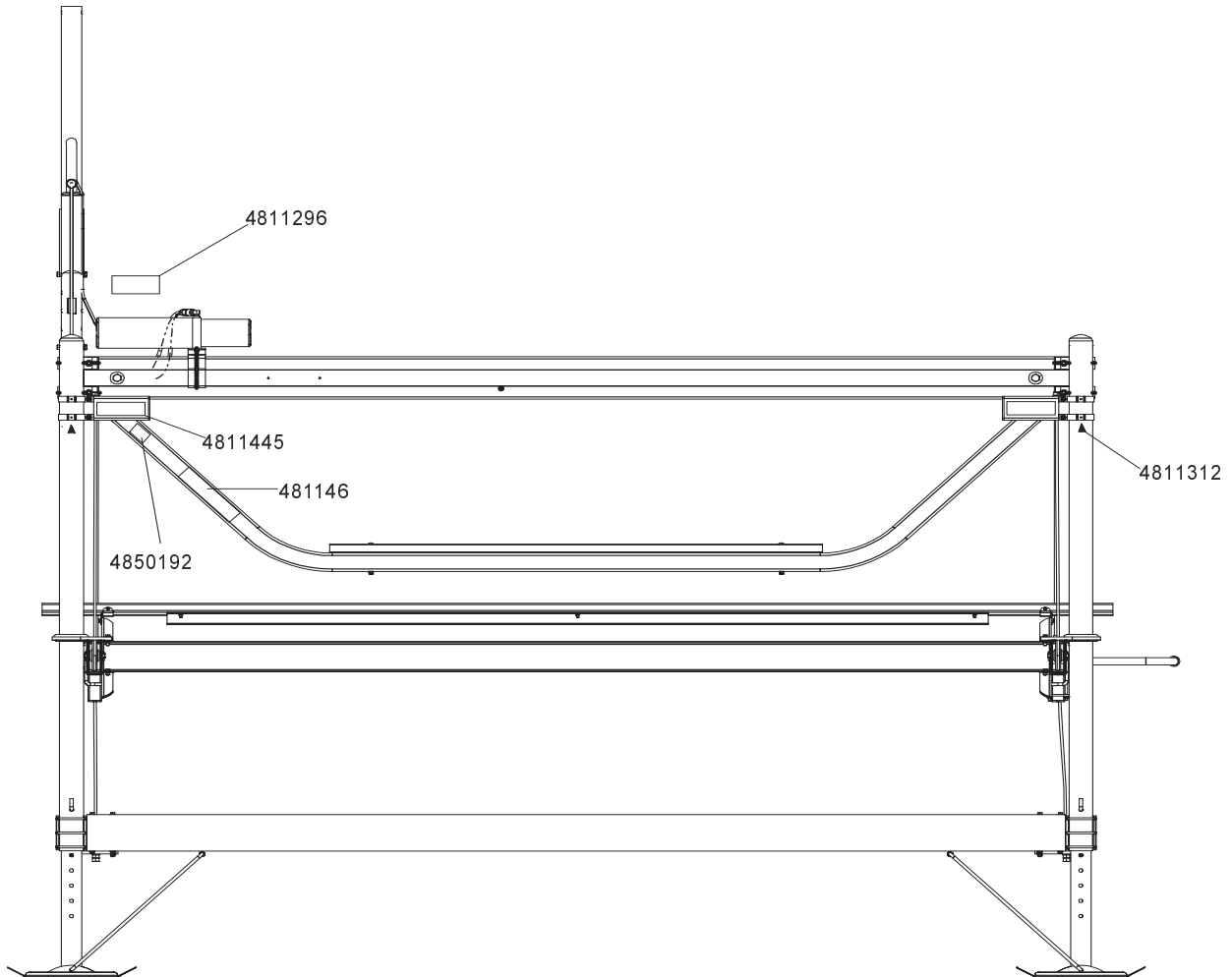

PART#	DESCRIPTION	QTY
4811445	DECAL SHORESTATION ORIGINAL/1959	2
4811446	DECAL CAUTION WARNING	1
4850192	DECAL CAUTION MAX LOAD 6000 LBS.	2
4811296	DECAL PIPE PLUG WARNING	1
4811312	DECAL CLAMP ARROW ALUMINUM HOIST ..	4

