

ADPM Aluminum Dock 45° Miter w/Polyvinyl Side Board

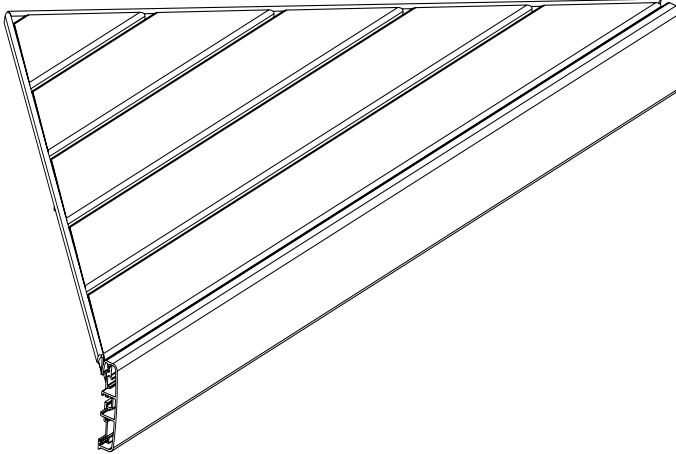

ADPM INSTALLATION INSTRUCTIONS

The polyvinyl dock system has a unique system designed into the aluminum side extrusion mounted on each side of every dock section. This extrusion is used not only to attach the polyvinyl sideboard to the side of the dock, but is also used to attach the “L” or “T” sections and the ADPM mitered corners to the main dock sections. The polyvinyl sideboards can simply be slid off the end of the aluminum extrusion exposing the “L” or “T” mounting legs. Align the outer edge of the “L” or “T” dock section with the end of the main dock section and drop the end connector of the “L” or “T” dock section onto the leg of the aluminum side extrusion. The “L” or “T” dock section can be secured onto the aluminum extrusion by rotating the latch pins on the bottom side of the dock section.

NOTE: IT IS IMPORTANT THAT THE DOCK SECTIONS ARE ADJUSTED LEVEL BEFORE INSTALLING AN ADPM MITERED CORNER.

4' WIDE DOCK SECTION FOR THE “L” OR “T”

Position the “L” or “T” dock section onto the exposed aluminum extrusion on the side of the main dock section and secure in position with the latching pins located on the bottom side of the dock section.

Installing the mitered corner requires you to slide the polyvinyl extrusion back on the “L” or “T” section far enough to expose the aluminum extrusion so the mitered corner can be attached to the aluminum extrusion. Place the mitered corner into position and push down until the extrusions mate. Secure in position by rotating the latch pins.

POLYVINYL CUTTING INSTRUCTIONS

Once in position, slide the polyvinyl extrusion back onto the aluminum extrusion until it is up against the plastic extrusion of the mitered corner. Using a T-square, scribe a line on the polyvinyl sideboard partially installed that corresponds with the end of the aluminum decking. Remove the polyvinyl sideboard several inches and cut on the scribed line.

The polyvinyl extrusion can be cut to length with a skill saw, hand saw, or utility knife. The objective is to get a straight even cut for appearance. When cutting with a saw, it works best to start at the top and cut down.

Once cut, slide the polyvinyl sideboard back in place.

A 4 ft. wide dock section and a mitered corner are not as wide as what the standard dock section is long. A short section of the polyvinyl sideboard removed from the main dock section can be cut in a similar manor described above to fill in the section of aluminum extrusion on the main dock section remaining uncovered.

A 6' AND 8' “L” OR “T” SECTION WILL ATTACH TO TWO DIFFERENT MAIN DOCK SECTIONS.

6' OR 8' WIDE DOCK SECTION FOR THE “L” OR “T”

Position the “L” or “T” dock section onto the exposed aluminum extrusion on the side of the main dock section and secure in position with the latching pins located on the bottom side of the dock section.

The width of a 6' or 8' wide dock section and an ADPM mitered corner is greater than the length of a standard dock section. It is therefore necessary to slide the polyvinyl sideboard from the second section forward so the mitered corner can be placed in position.

Installing the mitered corner requires you to slide the polyvinyl extrusion back on the “L” or “T” section far enough to expose the aluminum extrusion so the mitered corner can be attached to the aluminum extrusion. Place the mitered corner into position and push down until the extrusions mate. Secure in position by rotating the latch pins.

Refer to polyvinyl cutting instructions.

MITER REMOVAL

Remove by pulling the latch pins out, then rotating them so the offset handle catches and holds the pin in the unlatched position. Raise the mitered corner up and remove.

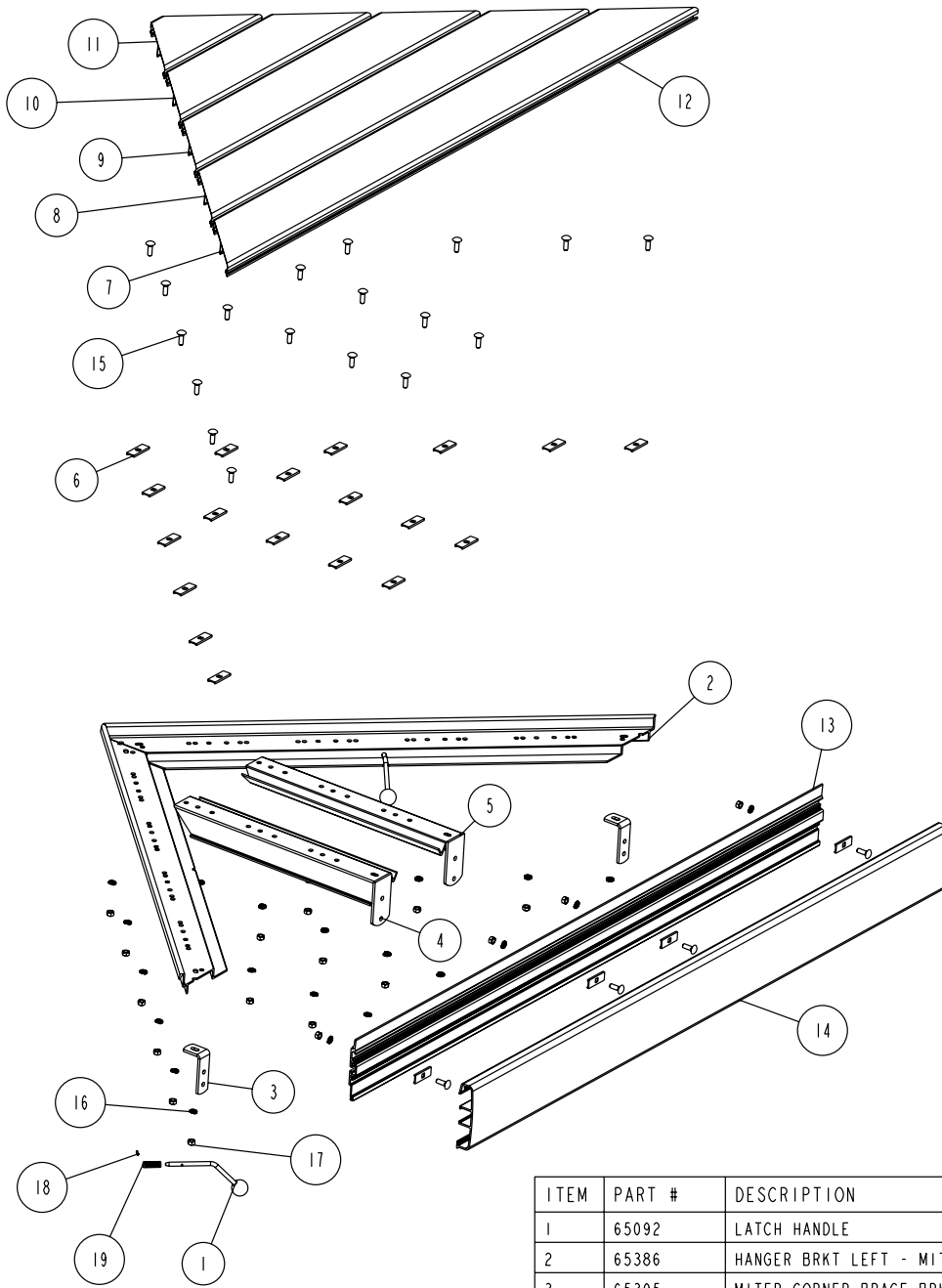

ITEM	PART #	DESCRIPTION	QTY	NOTE
1	65092	LATCH HANDLE	2	
2	65386	HANGER BRKT LEFT - MITER CORNER	2	
3	65395	MITER CORNER BRACE BRKT	2	
4	65440	CROSS MEMBER SHORT	1	
5	65441	CROSSMEMBER WMENT SHORT RIGHT	1	
6	66930	DECK CLAMP ALUM DOCK	23	
7	66956	ALUM DECK MITER EXT	1	
8	66957	ALUM DECK MITER EXT	1	
9	66958	ALUM DECK MITER EXT	1	
10	66959	ALUM DECK MITER EXT	1	
11	66960	ALUM DECK MITER EXT	1	
12	66961	ALUM DOCK MITER SUB-ASSY	1	
13	68794	ALUM EXT - ADP DOCK SIDE	1	
14	68795	PLASTIC EXTR - ALUM DOCK MITRE	1	
15	0210058	CARR 5/16-18 X 1 GR5 SS	23	
16	1350025	LOCKWASHER 5/16 S/T MED	23	
17	1450069	HEX NUT FINISH 5/16-18	23	
18	1540407	ROLL PIN - 1/8 X 1/2"	2	
19	2121222	SPRING COMPRESSION STAINLESS DOC	2	