

CP30A Canopy Post Bundle for the SSD8521

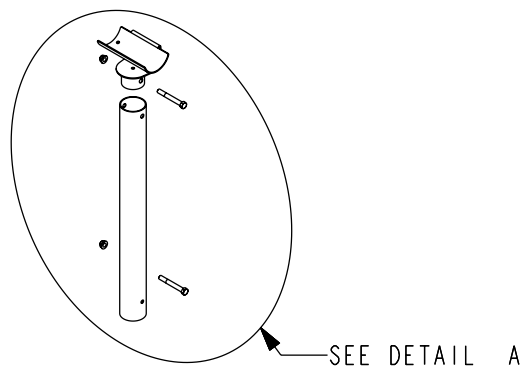
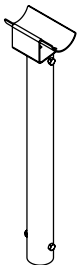
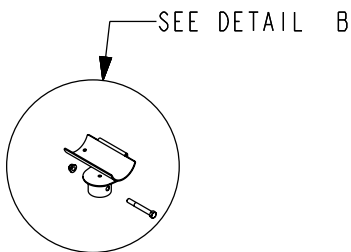

Assembly / Installation Instructions

Locate support cups in bundle 69020 and the non-adjustable canopy legs in bundle 68322. Attach two (2) of the A175 support cups to the non-adjustable legs using the 1/2" X 4" hex bolts and secure with flange lock nuts.

Attach the other two (2) A175 support cups to the winch legs of the hoist using 1/2" X 4" hex bolts and secure with flange lock nuts.

Insert the non-adjustable legs into the short rear legs of the hoist. Align the holes and insert 1/2" X 4" hex bolts and secure with flange lock nuts.

Tighten all hardware.

Installation is now complete.

